

PROGRAM
78th Annual Meeting
of the Southeastern Division of the AAG



Hosted by
Old Dominion University
November 18-20, 2023
Norfolk, Virginia

SEDAAG Sponsors

ESRI

American Association of Geographers

Mississippi State University, Department of Geosciences

Old Dominion University College of Art and Letters

Old Dominion University, OpenSeas Technology Innovation Hub

Old Dominion University, Institute of Coastal Adaptation and Resilience

Texas Tech University

University of Oklahoma, Department of Geography and Environmental Sustainability

University of North Carolina, Charlotte, Department of Geography and Earth Sciences

University of Richmond, School of Professional and Continuing Studies

Virginia Tech, Center for Coastal Studies

Virginia Tech, Department of Geography

Virginia Geographic Alliance

SEDAAG Executive Committee

President Bill Graves, University of North Carolina, Charlotte

Vice President Amy Potter, Georgia Southern University

Secretary Mark Sciuchetti, Jacksonville State University

Treasurer Paul McDaniel, Kennesaw State University

Past President Lynn Resler, Virginia Tech

Regional Councilor Heidi Lannon, Santa Fe College

SEDAAG Steering Committee

Members of the Executive Committee (see above)

Editors, *Southeastern Geographer* Shrinidhi Ambinakudige and Brian Williams, Mississippi State University

Alabama State Representative Jordan Cissell, Samford University

Florida State Representative Johanna Engström, University of Florida

Georgia State Representative Helen Rosko, Georgia Southern University

Kentucky State Representative Michele Abee, Bellarmine University

Mississippi State Representative Caleb Smith, Jones College

North Carolina State Representative Derek Martin, Appalachian State University

South Carolina State Representative Dean Hardy, University of South Carolina

Tennessee State Representative Craig Laing, University of Tennessee, Chattanooga

Virginia State Representative Jennifer Whytlaw, Old Dominion University

West Virginia State Representative Tom Saladyga, Concord University

Student representative to the Steering Committee Ryley Harris, Virginia Tech University

2023 SEDAAG Program Committee

Program Chair Amy Potter, Georgia Southern University

Members SEDAAG Executive Committee

2023 SEDAAG Local Arrangements Committee

Nicole Hutton, Old Dominion University
Jonathan Leib, Old Dominion University
Tom Allen, Old Dominion University
Jennifer Whytlaw, Old Dominion University
Ryley Harris, Old Dominion University
Tom Chapman, Old Dominion University
Timothy Kidd, Old Dominion University
Jessie Hobbs, Old Dominion University
Vinecia Bunch, Old Dominion University

Officers, American Association of Geographers

President Rebecca Lave, Indiana University
Vice President Patricia Ehrkamp, University of Kentucky
Secretary Dydia DeLyser, California State University, Fullerton
Treasurer Marcia England, Miami University
Past President Marilyn Raphael, UCLA Department of Geography
Executive Director Gary Langham, American Association of Geographers
Southeastern Regional Division Councilor Heidi Lannon, Santa Fe College

SEDAAG Honors Committee

Co-Chairs Joyce Clapp, University of North Carolina, Greensboro; Michele Abee, Bellarmine University
Committee Members Michael Ewers, UNC Charlotte; Jonathan Kozar, Marshall University; Ingrid Luffman, East Tennessee State University; Saeideh Gharehchahi, Jacksonville State University.

World Geography Bowl Committee

Event Organizers: Dawn M. Drake, Tom Bell, Ethan Bottone, Jamison Conley, Dennis Edgell, Jerry Griffith, Peggy Gripshover, Joshua Hodge, Jeff Neff, Lee Ann Nolan, Michael Pretes, Caleb Smith, and Chase Womack

Moderators: Dawn Bowen, Jamison Conley, Paul McDaniel, and Chase Womack

Judges: Shane Canup, Jerry Griffith, Joshua Hodge, and Carol Samuelson

Scorekeepers: Ethan Bottone, Ingrid Luffman, Mark Sciuchetti, and Caleb Smith

Master Scorekeeper Lee Ann Nolan

Team Coordinators:

Alabama: Matthew Balentine, University of North Alabama

Florida: Johanna Engström, University of Florida

Kentucky: Jack Swab, University of Kentucky

Tennessee: Wil Tollefson, East Tennessee State University

Virginia: Dawn Bowen and Joe Nichols, University of Mary Washington

Finals Round Volunteers

Moderator: Dawn M. Drake

Scorekeeper: Lee Ann Nolan

Judges: Shane Canup, Joshua Hodge and Chase Womack

Dream Team

Patricia Ehrkamp, AAG Vice President, University of Kentucky

Bill Graves, SEDAAG President, University of North Carolina, Charlotte

Jamison Conley, Director of AAG World Geography Bowl, West Virginia University

Jonathan Leib, 2023 Organizing Committee, Old Dominion University

Geoffrey Habron, 2024 Organizing Committee, Furman University

Joshua Hodge, University of Tennessee, Chattanooga

PROGRAM AT A GLANCE

Saturday, Nov. 18		
TIME	EVENT	LOCATION
10:30 AM-Noon	Fieldtrip: Norfolk Waterfront Soundwalk	Main Lobby
2-6 PM	Fieldtrip: Coastal Geography of Southeastern Virginia	Main Entrance
6-7 PM	Executive Committee Meeting	Montpelier

Sunday, Nov. 19		
TIME	EVENT	LOCATION
8 AM – 7 PM	Registration is open all day	Grande Promenade
8:30 - 11:00	Steering Committee Meeting & Breakfast	Riverview
9 AM-1 PM	Fieldtrip: Fort Monroe National Monument	Main Entrance
11:00 - 11:45	World Geography Bowl Registration	Poplar/Providence
11:45	World Geography Bowl Orientation	Poplar/Providence
12:00 - 3:30	World Geography Bowl Round Robin Competition (winning teams and all-star team announced immediately following conclusion of Round Robin Competition)	Poplar/Providence, Claremont, Brandon, Merimac, and Monticello
3:00 – 4:00	<i>Southeastern Geographer</i> Social Event	Grande Promenade
4:00 - 6:00	Paper and Poster Sessions	See Program
6:00 – 7:30	Welcoming Reception Keynote, Dr. Jessica Whitehead, Executive Director for the Institute Coastal Adaptation and Resilience	Riverwalk

Monday, Nov. 20		
TIME	EVENT	LOCATION
7 AM - 1 PM	Registration	Grand Promenade
7:00 - 8:00	Status of Women in Geography Breakfast <i>(group members only)</i>	Riverwalk
7:50 - 5:10	Paper, Poster, and Panel Sessions	See Program
8:00 - 4:00	Southeastern Geographer Photo Competition	Grande Promenade

12:00 – 1:00	Stand-Alone Geographers (SAGE) Lunch <i>(group members only)</i>	Merimac
	Young Professionals Lunch <i>(group members only)</i> Keynote: Dr. Matt Gerike, Geospatial Program Manager Virginia Geographic Information Network (VGIN), Virginia Department of Emergency Management (VDEM) Sponsored by Virginia Geographic Alliance (VGA)	Monticello
5:00 - 6:00	SEDAAG Business Meeting	Monticello
6:00 - 7:15	World Geography Bowl Championship	Poplar/Providence
7:30 - 9:30	Honors Banquet and Plenary Address	York/Stratford

SUNDAY

November 19

3:00pm – 4:00pm

Southeastern Geographer Social Event

4:00pm - 6:00pm

Undergraduate Posters & Undergraduate Student Poster Honors Competition

POSTER SESSION	Location:	York/Stratford
Undergraduate Posters & Undergraduate Student Poster Honors Competition		

Organizers: Sponsored by the SEDAAG Education Committee

Chair: Jennifer Rahn

Arctic Amplification and Their Drivers on the Mid-Latitude Polar Jet	Erin McCafferty Jason Ortegren	University of West Florida University of West Florida
Using GIS to Explore Socio-Economic and Environmental Injustices	Kaylin Colvin-Reece	University of West Florida
Spatial Analysis of Tree Species Near the Thompson Bayou	Hazel Heffernan Zhiyong Hu	University of West Florida University of West Florida
Renovations and Removals: Determining the Carbon Storage Capacities Lost by Tree Removals and Proposing Solutions	Emery Elkinson Todd Lookingbill Beth Zizzamia	University of Richmond University of Richmond University of Richmond
How Does a City's Local Context Shape the Content of its Climate Action Plan?	Andres Ospina Matthew Cohen	Furman University Furman University

Analysis of Justice Outcomes in City Climate Action Planning in the United States	Miles Baker Matthew Cohen	Furman University Furman University
Desert locust habitat predictive modeling under future climate scenarios and sustainable management strategies using GIS and Remote Sensing Approaches.	Mimi Haase Suresh Muthukrishnan	Furman University Furman University
Assessing the Urban Heat Island Effect and Its Impacts in Greenville, SC using Remote Sensing and Ground Based Measurements	Reagan Ogburn Suresh Muthukrishnan	Furman University Furman University
TRIs and Wildfires: Country-Wide Analysis	Spencer Harris Lucas Stebbins Amanda Hoffman-Hall	Eckerd College Eckerd College Eckerd College
GIS and Social Media: Trends in Technology and Applications to Mass Shooting Prevention	Abby Stovall	Concord University
Expanding the Pine Woodland Fire History Record at New River Gorge National Park and Preserve	Haidyn DePinho	Concord University
Health of Deer in Urban, Suburban, and Rural Environments	Oriana Ballotta Garman	University of Richmond
Industrial Wildfire Risk: Western U.S. T.R.I. Facilities at Risk of Wildfire	Lucas Stebbins Spencer Harris Amanda Hoffman-Hall	Eckerd College Eckerd College Eckerd College
An Analysis of Biking and Pedestrian Safety in Greenville, South Carolina	Lindsay Cribbs Suresh Muthukrishnan	Furman University Furman University
Analysis of Food Access in Lauderdale County, AL	Ethan Burbank	University of North Alabama
Assessing the current status of climate change adaptation in Sri Lanka	Hannah Garbutt Eranga Galappaththi	Virginia Tech Virginia Tech
Detecting Vegetation Changes Following an EF-4 Tornado in Katie, Oklahoma	Elisa Luckabaugh Marco Millones	University of Mary Washington University of Mary Washington
Determination of Heavy Metal Concentrations in Plants on Polluted Soil Along Mobile River— AL	Noah White Johan Libens	University of West Florida University of West Florida
Violent Group Physical Distribution: Colombia and Mexico	Riley Speas	University of Tennessee, Knoxville
The Economics of Sustainable Energy Futures: A Multi-Faceted Analysis of Richmond Gas Works	Caitlin Fay Mary Finley-Brook	University of Richmond University of Richmond
Bays vs Oceanfront: Impacts of Artificial Light on Marine Ecosystems	Eli Beech-Brown Faye Parker Kyle Redican Beth Zizzamia	University of Richmond University of Richmond University of Richmond University of Richmond
The Impact of 1950s Interstates on Jackson Ward, Richmond	Elliot Delroba	University of Richmond
James River City Park Systems Invasive Species Mapping and Assessment	Gloria Kroodsma Kyle Redican Todd Lookingbill	University of Richmond University of Richmond University of Richmond
Creating a Tool to Analyze Fuzzy Boundaries	Jack DuPuy Kyle Redican	University of Richmond University of Richmond

Reconstructing Unity: Empowering Reconnections Post-Interstate Highway Deployments with Geospatial Tools	Sydney Cassady Kyle Redican Elizabeth Zizzamia	University of Richmond University of Richmond University of Richmond
Dating the Broylesville Mill, Washington County, Tennessee, USA Using Dendrochronological Methods	A.J. Heichelbech Maegen L. Rochner	University of Louisville University of Louisville
Exploring Patterns of Thunderstorm Initiation Using Cluster Analysis: A Case Study of the Washington D.C. Region	Lucie Griffith Mace Bentley Dudley Bonsal Tobias Gerken Zhuojun Duan Henry Way	James Madison University James Madison University James Madison University James Madison University James Madison University James Madison University James Madison University
The Wildland-Urban Interface: Oregon Toxic Release Facilities at Risk of Wildfire	Ella Glass Amanda Hoffman-Hall	Eckerd College Eckerd College
The Environmental Injustices of Fracking	Nate Kromkowski Alexander McVicker Naveen Joseph	Radford University Radford University Radford University
Transportation Infrastructure Expansion in the State of Acre, Brazilian Amazon	Megan Montoya	University of Richmond
Monitoring of Forestry Roads and Transportation Infrastructure in the Amazon Borderlands of Ucayali, Peru and Acre, Brazil	Tim Babchak	University of Richmond
Uaka Katonko: A Transboundary Cultural and Ecological Initiative in the Amazon Borderlands of Peru and Brazil	Delaney Demaret David Salisbury Nereida Sosa Antunez Cooper Woods Valdete da Silva Pinhanta (Wewito Piyãko) Francisco Piyãko Arlindo Ruíz Santos Maria Elena Paredes Márquez Andrés Arévalo Pérez Alfonso Rengifo Pérez William Villacorta Portocarrero Chris Fagan	University of Richmond University of Richmond University of Richmond University of Richmond APIWTXA Cooperative OPIRJ Upper Amazon Conservancy Sawawo-Hito 40 Native Community Alto Tamaya Saweto Native Community ACONADIYSH Upper Amazon Conservancy Upper Amazon Conservancy
Simulating the Causes of the 1958 Lituya Bay Tsunami Using HAZUS	Emily Spingarn Charles Manyara	Radford University Radford University
The Wildland Urban Interface: Assessing Wildfire Risk For Toxic Release Facilities in Nevada	Diana Price Amanda Hoffman-Hall	Eckerd College Eckerd College
Wind Disaster Strikes: Mapping 30 Years of Georgia's Severe Wind Events	Max White	University of Georgia
Analyzing Spatial Trends in the Opioid Overdose Crisis in North Carolina	Amanda Halbert	Appalachian State University

Lee County's Emergency Management Communication Strategies impact on 65+ Population	Jamellah Jackson	The University of South Florida and Florida A&M University
---	------------------	--

4:00pm - 6:00pm

Paper Sessions

Each paper time slot is 20 minutes long: 15 minutes for the paper presentation followed by 5 minutes of audience/presenter discussion. Please respect the chairperson's time cues.

SPECIAL PAPER SESSION

Location: Eppington

Advancing Physical Geography through Experiential Learning

Organizer: Lynn M. Resler, Virginia Tech

Chair: Lynn M. Resler, Virginia Tech

Session description: Cultivating student enthusiasm for physical geography is essential for the discipline's future. One impactful educational approach that achieves this objective is experiential learning, which strongly emphasizes direct experience and active participation. Physical geographers are uniquely positioned to harness the strength of experiential learning by facilitating direct interactions with the physical environment. Experiential learning can enhance comprehension and boost motivation, engagement, and the ability to make interdisciplinary connections—vital elements for the continued growth and diversification of the discipline. This session will serve as a platform for exchanging insights about planning and implementing experiential learning activities related to physical geography.

4:00	RARE: A Novel Paradigm for Interdisciplinary Undergraduate-led Research and Scholarship Abroad	R. Stockton Maxwell J.E. Caughron J.J. Caughron J.E. Davis	Radford University Radford University Radford University Radford University
4:20	Fieldwork as a Gateway Drug: How the United Kingdom mastered geography recruitment; a case study from Kings College London	Heidi Lannon	Santa Fe College
4:40	Physical Geography for the People: Field-Based Learning Opportunities and Challenges at a Primarily Undergraduate Institution	Thomas Saladyga	Concord University
5:00	Experiential Learning for King Tides and Sea Level Rise: The Blue Line Project in Coastal Geography	Thomas Allen	Old Dominion University
5:20	Physical Geography on Ice: A Study Abroad Experience to the Antarctic Peninsula	Lynn Resler	Virginia Tech

PAPER SESSION

Location: Greenway

Black Geographies I

Chair: Rob Brown, Appalachian State University

4:00	Where's the Food? Food Insecurity and Black Food Geographies in the Mississippi Delta	Taylor Patterson Brian Williams	Mississippi State University Mississippi State University
------	---	------------------------------------	--

4:20	Recovering a Black Cemetery: Automated Mapping of Hidden Gravesites using an sUAV and GIS in East End Cemetery, Richmond, VA	Elizabeth Zizzamia Stephanie Spera Matthew Franklin Ryan Smith	University of Richmond University of Richmond University of Richmond Virginia Commonwealth University
4:40	Meet the Boys on the Battlefield: Searching for Lost Cultural Landscapes of Black Masking Indians	Rob Brown	Appalachian State University

PAPER SESSION

Location: Brandon A

Environmental Justice in the South

Chair: Richard Milligan, Georgia State University

4:00	An Analysis of the Interplay Between Segregation and Environmental Injustice in North Port St. Joe, Florida from 1935-1999	Nelson Kowu Kwame Owusu-Daaku	University of West Florida University of West Florida
4:20	The Geography of Environmental Justice in 'Kentuckiana'	Michele Abee	Bellarmino University
4:40	Stranger Things: Exploring the Infrastructures of Pollution in Columbia, SC	Jill Thornton David Kneas	University of South Carolina University of South Carolina
5:00	Repairing environmental injustice or redoubling racial harms in sustainable redevelopment of Atlanta's Quarry Yards?	Richard Milligan Katherine Hankins Sarah Ledford	Georgia State University Georgia State University Georgia State University

PAPER SESSION

Location: Brandon B

Political Geographies

Chair: Chase Womack, University of North Carolina at Greensboro

4:00	Spatiotemporal Analysis of Labor Violations in the Southeastern USA to Inform Proactive Outreach for Combatting Labor Trafficking	Kayla Stan Kimberly Hogan	University of Southern Mississippi University of Southern Mississippi
4:20	Using deep learning and high resolution satellite imagery to predict conflict in urban areas	Scott Warnke Dan Runfola	William & Mary William & Mary
4:40	The Most Confusing Line on the Map: Examining Northern Virginia's Elusive Border	Ricky Munoz	University of Mary Washington
5:00	Border interactions and landscapes between São Borja (Brazil) and São Tomé (Argentina)	Edgar Velozo	University of Kentucky
5:20	Geographies of Abandoned Spaceports	Chase Womack	University of North Carolina, Greensboro

PAPER SESSION

Location: Riverview

Climatology

Chair: Corene Matyas, University of Florida

4:00	Georgia's Hurricane Climatology from 1851-2021	Reilly Corkran	Louisiana State University
4:20	Using the Community Earth System Model to study the dynamics of drought in the Circum-Caribbean	Dimitris A. Herrera	University of Tennessee, Knoxville

4:40	Examining differences between point-matched and mosaicked reflectivity values from multiple radars for two tropical cyclones	Corene Matyas Zainab Ali Kimberly Wood Stephanie Zick	University of Florida University of Florida University of Arizona Virginia Tech
5:00	The Evolution and Distribution of Precipitation during Tropical Cyclone Landfall	Samrin Sauda Stephanie Zick	Penn State University Virginia Tech
5:20	Detecting and Mapping Mobile Home Parks in and around Athens, Georgia using High-Resolution Planet Satellite Imagery and Machine Learning Classification	Kayleigh Taillefer	University of Georgia

4:00 pm - 6:00pm

Panel Session

PANEL SESSION

Location: Claremont

Transitioning In/Between Graduate School: Lessons Learned From Students

Organizer: Annie Liu, University of Tennessee, Knoxville

Chair: Annie Liu, University of Tennessee, Knoxville

Panelists: Annie Liu, Seth Kannarr, Margaret Walton, and Cooper Corey, University of Tennessee, Knoxville; Prabish Khadka Chletri and Emmanuel Aklie, Jacksonville State University; Jack Swab, University of Kentucky; Fikriyah Winata, Mississippi State University

Session Description: For graduate students, the transition between graduate programs, between undergraduate and graduate, or between being in the workforce and graduate school, can be very difficult. This panel seeks to invite guests to listen to our panelists share any advice and their experiences transitioning in/between graduate school to help prospective graduate students have a better understanding of what to expect. We hope to cover topics of applying to graduate school, settling into graduate school, making and maintaining connections with fellow graduate students, work-life balance, creating priorities in graduate school, and imposter syndrome. We will also engage with participants/audience members by asking for their advice, experiences, and concerns about graduate school as well.

6:00pm – 7:30 pm

Welcome Reception	Riverwalk
-------------------	-----------

Monday

November 20

7:00am – 7:50am

Status of Women in Geography Breakfast (<i>group members only</i>)	Location: Riverwalk
--	---------------------

Paper, Panel and Poster Sessions

Each paper time slot is 20 minutes long: 15 minutes for the paper presentation followed by 5 minutes of audience/presenter discussion. Please respect the chairperson's time cues.

7:50am – 9:50am

POSTER SESSION

Location: York / Stratford

Graduate Honors Student Poster Competition

Organizer: Sponsored by the SEDAAG Honors Committee

Co-Chairs: Michele Abee and Joyce Clapp

Refinement of Satellite Precipitation Estimates Using Hybrid Downscaling and Machine Learning in the Upper Awash River Basin, Ethiopia	Bewuket Tefera	University of Florida
Remote Sensing of Georgia Tidal Marsh Habitats using High-Resolution Aerial Photography	Harrison Currin	University of North Carolina, Chapel Hill
Hit Without Warning: Public Risk Perception During an Unwarned Tornado	Cooper Corey	University of Tennessee, Knoxville
Precision Land Use and Land Cover Mapping in Addo Elephant National Park through Landsat-8 and Google Earth Engine	Mohammad Safaei	University of Florida
Resilience and Challenges: Deep Learning Analysis of Stellenbosch Vineyards Amidst Economic and Competitive Pressure	Torit Chakraborty	University of Florida
Comparing Spatial Structure of Total Rainfall for Four Major Tropical Cyclones from 2000 to 2020 by Using IMERGE Data: A Case Study of Bangladesh	Airin Akter	University of Florida
Immigrant Food Entrepreneurs: the Resilient Group that enhances the Social Identity of Immigrant Communities in Florida	Donal Bissainte	University of Florida
Walkability Mapping: Integrating GIS Analysis and Community Perspective on the Texas Tech Campus	Gisou Salkhi Khasraghi	Texas Tech University
A Geospatial Analysis of Pre-Exposure Prophylaxis Access Along Georgia Fixed-public transit Routes	Farnoosh Roozkhosh	University of Georgia
Transitioning to Zero Emission Vehicles (ZEV) in North Carolina: Understanding the Adoption Factors for Passenger Electric Vehicles.	Sheila Jebiwot	University of North Carolina, Greensboro
Risk of Coastal Flooding on US military installations: A Case Study of MCRD Parris Island	Charles Kenneth Fladhammer	Virginia Tech
Assessment of Land Surface Temperature Trends in Greater Accra Region, Ghana and Their Implications on Public Health	Gideon Tandoh	Jacksonville State University
A City in the Forest for Some: Mapping the relationship between greenspace access and housing affordability in the City of Atlanta	Avery Evans	Georgia State University

Charting the Path for the Tennessee Mesonet: Assessing Suitability and Feasibility for Site Location	Tristan Holmes	East Tennessee State University
Glacier of the western United States: Assessment of Area and Volume changes since 1940s using Sentinel- 2A images and Machine Learning Algorithm	Bernard Abubakari	Mississippi State University
Applying Inverse Distance Weighting (IDW) for the estimation of PM2.5 concentrations in El Paso, Texas.	Ummat Safwat Sristy	Texas Tech University
Adaptive Co-Management and Maladaptation in Coastal Indigenous Community of Akplabanya, Ghana	Brandy Ayesu-Danso	Virginia Tech
Disseminating Research on Salt Marsh Dieback Using a StoryMap Approach	Jade Lee	Georgia Southern University
Community Disaster Preparedness: How Education Changes Household Preparedness for Resilience	Emma DiPuma	University of Georgia
Assessing Urban Livability of Khulna City, Bangladesh, Using GIS Based Multi Criteria Approach	Pankaj Kanti Jodder	University of North Carolina Charlotte
Atlanta Road and Waterway Litter: Waterway Risk Determined by Interstate and Highway Litter Data	Kelly Cronin	Georgia State University
Disparities in Spatial Clustering of Perinatal Mental Health Conditions During the COVID-19 Pandemic	Sarah Ulrich	Appalachian State University
Historical Analysis of Presidential Elections in Appalachia	Taylor Carter	University of North Alabama

7:50am – 9:50am

Paper Sessions

Each paper time slot is 20 minutes long: 15 minutes for the paper presentation followed by 5 minutes of audience/presenter discussion. Please respect the chairperson's time cues.

SPECIAL PAPER SESSION

Location: Eppington

Innovations in Economic Geography

Organizer: Ron Kalafsky, University of Tennessee, Knoxville

Chair: Ron Kalafsky, University of Tennessee, Knoxville

7:50	Urban and Rural Health Deserts in the Southeast: Socioeconomic Impacts and Diverging Trends	Brett Davis Jesse Lane	Auburn University at Montgomery Northwest Missouri State University
8:10	Global Connections and the South: Looking at the Exports of Larger MSAs	Ron Kalafsky	University of Tennessee, Knoxville
8:30	Almost Heaven: Transportation, Energy, and Steel - West Virginia's Economic Development Prospects	Jonathan Kozar	Marshall University
8:50	Views of the Future: Removing Epistemological Roadblocks to a Predictive Economic Geography	William Graves	University of North Carolina, Charlotte

9:10	What are the Emerging Contours of Regional Industrial Decarbonization? Evidence from a Rapid Analysis of US Clean Hydrogen Hubs	Michael Ewers Christian Brannstrom Caitlin Conrecode	University of North Carolina, Charlotte Texas A&M University University of North Carolina, Charlotte
------	---	--	--

SPECIAL PAPER SESSION

Location: Greenway

Practical Applications of NASA Earth Observations

Organizer: Amanda Clayton, NASA DEVELOP Program

Chair: Amanda Clayton, NASA DEVELOP Program

7:50	The NASA DEVELOP Model of Capacity Building & Community Science	Lauren Childs-Gleason	NASA DEVELOP Program
8:10	Monitoring Temperature and Vegetation to Detect River Flow Impediments at Energy Intake Structures	Marisa Smedsrud	NASA DEVELOP Program
8:30	Tracking and Assessing Stormwater Flooding in Richmond, Virginia, to Improve Water Quality Monitoring and Resources Management	Olivia Landry	NASA DEVELOP Program
8:50	Using Earth Observations to Assess Hydrologic Changes and Wildfire Risk in the Okefenokee Swamp	Laramie Plott	NASA DEVELOP Program

PAPER SESSION

Location: Riverview

Black Geographies II

Chair: Derek Alderman, University of Tennessee, Knoxville

7:50	Harmonizing Geographies: The landscapes and soundscapes of the SNCC Freedom Singers	Margaret Lane Walton Derek Alderman	University of Tennessee, Knoxville University of Tennessee, Knoxville
8:10	On the Longer View of Black Naming Activism: SNCC Freedom Houses as Revolutionary Place-Making	Derek Alderman Joshua Inwood Katrina Stack	University of Tennessee, Knoxville Penn State University University of Tennessee, Knoxville
8:30	In Their Own Words: Black Farmers in Appalachian Kentucky in the 21st Century	Jed DeBruin	University of Kentucky
8:50	Journey through Justice: Unearthing Anniston's Civil Rights Legacy Amidst National Demonstrations	Mark Sciuchetti Jianping Huang	Jacksonville State University Jacksonville State University
9:10	A Kentucky State of Mind: bell hooks and a Geography of Subjectivity	C. Shawn McGuffey	Boston College

PAPER SESSION

Location: Montpelier

Urban Geographies

Chair: Selima Sultana, University of North Carolina, Greensboro

7:50	Mapping Absenteeism: Visualizing the Multiple Scales of Absentee Property Ownership in Atlanta, Georgia	Taylor Shelton Ryan Pardue	Georgia State University Georgia State University
------	---	-------------------------------	--

8:10	A Comparative Geostatistical Analysis of a Raster-Based Metric to Other Traditional Vector-Based Metric for Food Availability Study	Samuel Akinnusi	North Carolina Central University
8:30	Assessing changes in the socioeconomic composition of the suburbs in Nashville – Is gentrification responsible?	Rafael Harun Morgan Gill	Tennessee State University Tennessee State University
8:50	Risk Assessment for Extreme Heat Events	Alex Arila	Georgia State University
9:10	Towards Fairness in Electric Vehicle Charging: Insights from Chicago and North Carolina	Gregory Carlton Selima Sultana Sheila Jebiwot	University of North Carolina, Greensboro University of North Carolina, Greensboro University of North Carolina, Greensboro

PAPER SESSION

Location: Brandon A

Medical Geography I

Chair: Jamison Conley, West Virginia University

7:50	Time Series Forecasting of Infectious Respiratory Diseases in the United States: Integrating Place Connectivity Networks from Geospatial Social Media Data with Deep Learning Models	Fengrui Jing	University of South Carolina
8:10	The geography of COVID-19 vaccine completion by age in North Carolina, U.S.	Hilary Sandborn Paul Delamater Noel Brewer Melissa Gilkey Michael Emch	University of North Carolina, Chapel Hill University of North Carolina, Chapel Hill University of North Carolina, Chapel Hill University of North Carolina, Chapel Hill University of North Carolina, Chapel Hill
8:30	The Effect of the Definition of Vaccinated on Identifying COVID Vaccination Hot Spots and Cold Spots	Jamison Conley Brian Hendricks	West Virginia University West Virginia University
8:50	Assessing the Impact of Trees Potential on Health and the Environment around the Mary Townes Science Building	Tony Esimaje	North Carolina Central University
9:10	Metastatistics Describing Social Vulnerability Indicators in the Region 7 District of North Carolina	Chima Okoli	North Carolina Central University

PAPER SESSION

Location: Brandon B

Human-Environment

Chair: Helen Rosko, Georgia Southern University

7:50	Does Shrimp Farming Impact Agricultural Production and Food Security in Coastal Bangladesh? Evidence from Farmer Perception and Remote Sensing Approach	Zia Ahmed Shrinidhi Ambinakudige	Mississippi State University Mississippi State University
8:10	Placing Statesboro: Development and Socio-Environmental Change in Bulloch County, Georgia	Emma Jane Vick Helen Rosko	Georgia Southern University Georgia Southern University

8:30	Beyond the Shiny Object: Regional Development & Socio-environmental Change in Coastal Georgia	Helen Rosko	Georgia Southern University
8:50	Private Land Conservation in Progressive-Era Miami-Dade County and Its Contemporary Environmental Legacies	Mason Bradbury	Florida International University
9:10	Archival Stratigraphy: Tracing fracture, sediment, and abundance with the geologic archive	Rachel Noble-Varney	University of Kentucky
9:30	Settlement Colonialism: ANCSA, the Willow Project, and Colonial-Capitalism in Alaska's North Slope	Hans Purisch	University of Kentucky

10:00am - 12:00 Noon

POSTER SESSION

Location: York / Stratford

General Poster Session

Predicting Cotton Above Ground Biomass Using Multispectral Imagery from Uncrewed Aerial Systems	Kyle Steen	University of Georgia
Spatial Analysis of the Prevalence of Dementia and Alzheimer's Disease	Genevieve Brunner Korine Kolivras	Virginia Tech Virginia Tech
Socioeconomic Drivers and Relocation Attitudes among Urban Residents along the US East Coast: A Spatial Perspective	Sophiya Gyanwali Anamaria Bukvic Junghwan Kim Thomas Crawford	Virginia Tech Virginia Tech Virginia Tech Virginia Tech
Quantifying Seasonal Changes in a Coastal Dune on Pensacola Beach, Florida	Kyle Allen Phillip Schmutz	University of West Florida University of West Florida
A Review of Offshore Drilling and Relevant Renewable Energy Legislation in the Gulf of Mexico	Mandy Celis Kwame Owusu-Daaku	University of West Florida University of West Florida
Rethinking the Polycentricity in the US after COVID-19: A New Urban Center/Subcenters Identification Approach	Kyle Redican Shaoting Wen Carlos Hurtado	University of Richmond University of Richmond University of Richmond
Am I My Brother's (River)Keeper? Transformative Change through Community-Based Stream Restoration	Todd Lookingbill Terry Dolson	University of Richmond University of Richmond
Minor League Baseball, Behind the Logo	Christopher Green	University of North Carolina, Pembroke
Voter Turnout by Precinct in Guilford and Rockingham Counties, North Carolina, November 3, 2020	Darrell Kicker	University of North Carolina, Greensboro
The role of the Great Plains Low-Level Jet in moisture transport to the Missouri River Basin	Erika Wise Matthew Dannenberg Gregory McCabe	University of North Carolina, Chapel Hill University of Iowa US Geological Survey
Engaging Students in Disaster Research and Preparedness	Michelle Ritchie	University of Georgia
Tornado Risk Perceptions and Sheltering Behaviors during the COVID-19 Pandemic in 2020	Jawata Saba Kevin Ash	University of Florida University of Florida
Teasing out the aeolian erosion effect in gullies primarily impacted by rain and freeze-thaw processes.	Ingrid Luffman Robert McSweeney Arpita Nandi	East Tennessee State University East Tennessee State University East Tennessee State University
Assessing the effectiveness of beaver dam analogs (BDA's) as a stream restoration technique: A case study from the Southern Appalachian foothills	Derek Martin Joshua Platt	Appalachian State University Appalachian State University

	Allison Ingram Grant Buckner	Appalachian State University Catawba Riverkeeper
Representation of the American South in North American Regional Geography Textbooks in the Twenty-First Century	Paul McDaniel	Kennesaw State University
A Decade of Urban Growth and Canopy Loss in the Upper Reedy River Watershed, Greenville County, South Carolina	Zachary Boota Suresh Muthukrishnan	Furman University Furman University
Flooding! Where, Why, and Now What?	Anita Walz	Marshall University
Mapping Socioeconomic and Demographic Changes Around Black History Museums in Philadelphia, PA, Using GIS	Rebecca Neely	Georgia Southern University
Chessie and Hampton Roads: Reconstructing Chesapeake and Ohio Railway Landscapes in the Hampton Roads Region Using Historical Imagery	Craig Laing	University of Tennessee, Chattanooga
Data-Driven Mobile GIS Supported Workflow for Efficient Landslide Risk Assessment Along Major Highways	Robert McSweeney Arpita Nandi	East Tennessee State University East Tennessee State University
Creating Memories in Community: Collaborative Interventions and Commemorative Practices in Saba's Adopt-A-Box Project	Jennifer Rahn	Samford University
Learning Activities Exploring Black Mobility in South Carolina	Kevin Hicks	University of North Carolina, Charlotte
Application of AI (Artificial Intelligence) in Groundwater Modelling	Ayush Chaudhuri	University of North Carolina, Greensboro
Creating Practicability Envelopes for UAS Bathymetric Sonar Data in Different Waterbodies of Mississippi State	Md Salman Bashit Narcisa Pricope	Mississippi State University Mississippi State University
Exploring the Obstacles of Electric Vehicle Transition	David Bjorkback Samuel Akinnusi	North Carolina Central University North Carolina Central University
Comparing Mangrove Deforestation Rates Inside and Outside of Protected Areas	Jordan Cissell Simi M. Komenda	Samford University James Cook University
Climate Trends and Variations Impacting Hazards in Tennessee: Exploring the 2023 Tennessee State Hazard Mitigation Plan Update	William Tollefson Andrew Joyner Joseph Harris Ingrid Luffman Emmanuel Afriyie Matthew Beer Tristan Holmes Fatimah Olawuyi Eileen Ernenwein Arpita Nandi Megan Quinn	East Tennessee State University East Tennessee State University East Tennessee State University East Tennessee State University East Tennessee State University East Tennessee State University East Tennessee State University East Tennessee State University East Tennessee State University East Tennessee State University East Tennessee State University
Climate change narratives: a story of three communities	Isaac Oluwatimilehin	University of Kentucky
The Human Impacts on Ulele and Purity Springs	Cameron Delgado Abby Suarez Phillip Van Beynen Christopher Meindl	University of Florida University of Florida University of South Florida University of South Florida

Deciphering Terrestrial LiDAR Streams: Tracking Human Movement in Shared Spaces	Shashank Karki Addison Flack Thomas Pingel Timothy Baird	Virginia Tech Virginia Tech Binghamton University Virginia Tech
Rolling the Dice: an Evolution of Digital Landscapes and Culture	Kaitlyn Anderson	University of Florida

SPECIAL PAPER SESSION

Location: Eppington

Floods, Floodplains, and Fluvial Studies

Organizers: Joann Mossa, University of Florida; Sarah Praskievicz, University of North Carolina, Greensboro

Chairs: Joann Mossa and Sarah Praskievicz

10:00	An Out-of-Control Water Control Project: The Geomorphic Evolution of Wax Lake Outlet and Lower Atchafalaya River Channels	Joann Mossa Yin-Hsuen Chen Jeremy Reynolds	University of Florida Old Dominion University Jones Edmunds
10:20	Enhancing stream burning method for LiDAR-driven digital elevation model in a coastal city	Yin-Hsuen Chen Tom Allen George McLeod	Old Dominion University Old Dominion University Old Dominion University
10:40	Evaluating Factors Driving Riverbed Deformation in a Large Lowland River	Amobichukwu Amanambu Joann Mossa	University of Alabama University of Florida
11:00	Sediment and organic carbon storage by the floodplains of tropical rivers within the Lake Tana Basin, NW Ethiopia	Girma Worku Awoke Karen Vancampenhout Enyew Adgo Amaury Frankl Gert Verstraeten	University of Florida KU Leuven Bahir Dar University Ghent University KU Leuven
11:20	Movement of large wood in urban streams	Rajesh Sigdel	University of North Carolina, Greensboro
11:40	Geomorphic impacts of large wood in Coastal Plain rivers of the Southeast US	Sarah Praskievicz Derek Martin	University of North Carolina, Greensboro Appalachian State University

PAPER SESSION

Location: Greenway

Commemoration and Tourism Geographies

Chair: Amy Potter, Georgia Southern University

10:00	Placing Black Agency and Voices in Fredericksburg's Commemorative Landscape	Mike Thrower Aimee Trehey Stephen Hanna	University of Mary Washington University of Mary Washington University of Mary Washington
10:20	Ole' Sparky: Affectivity and the ethics of displaying the electric chair in McAlester, Oklahoma	Katrina Ward	University of Kentucky
10:40	Left-Wing Nationalist-Populist Movement and Identification: A Psycho-Political Analysis of the "Comfort Woman" Statue Movements in South Korea	Jaeyeon Lee	Hollins University

11:00	"It's In Our DNA:" Remembering the 1798 Rebellion 225 Years Later in County Wexford, Ireland	Amy Potter Jackson Havens Alexander Perry	Georgia Southern University Georgia Southern University Georgia Southern University
11:20	Atmospheric Instability in Dark Tourism: Spatial Construction of Conflicting Affective Atmospheres at the Titanic Museum & Attraction, Pigeon Forge, Tennessee	Ethan Bottone Derek Alderman Stefanie Benjamin Sarah Frankel	Northwest Missouri State University University of Tennessee, Knoxville University of Tennessee, Knoxville University of Tennessee, Knoxville
11:40	What's In a Name? A New Criteria System for U.S. NPS Sites	Seth Kannarr	University of Tennessee, Knoxville

PAPER SESSION

Location: Riverview

Medical Geography II

Chair: Fikriyah Winata, Mississippi State University

10:00	Virtual Fieldwork in Human Geography Research: Lessons from Collecting Online Activity Diary, Interview, and Survey Data during the Pandemic	Fikriyah Winata	Mississippi State University
10:20	The Ghanaian War Against Malaria: A Geospatial Approach to Malaria and Healthcare Access in Ghana	Emmanuel Narteh Aklie Mark Sciuchetti	Jacksonville State University Jacksonville State University
10:40	Community perceptions associated with malaria endemicity in Chittagong Hill Tracts, Bangladesh	Mahjabin Kabir Adrita Korine Kolivras Thomas Crawford Eranga Galappaththi	Virginia Tech Virginia Tech Virginia Tech Virginia Tech Virginia Tech
11:00	Spatial Expansion of Lyme Disease in Appalachia (2000-2019)	Geoffrey Otieno Korine Kolivras Junghwan Kim Corrine Ruktanonchai	Virginia Tech Virginia Tech Virginia Tech Virginia Tech
11:20	Bodily Scars as Cartographic Reimaginings	Bethany Craig	University of Kentucky
11:40	Shaping the Region: Moral Economies of Anti-Fatness in the U.S. South	Annie Elledge	University of North Carolina, Chapel Hill

PAPER SESSION

Location: Montpelier

Climate Change and Hazards

Chair: Paul Knapp, University of North Carolina, Greensboro

10:00	Wall to wall coverage: Broadcast media interpretation and dissemination of risk during an undetected tornado	Kelsey Ellis Melanie Faizer Cooper Corey Jennifer First	University of Tennessee, Knoxville University of Tennessee, Knoxville University of Tennessee, Knoxville University of Tennessee, Knoxville
10:20	Exploring the Impact of Geographic Context on Tornado Risk: A Spatial-Statistical Case Study	Sarah Jackson	Western Carolina University

10:40	Remote Sensing and GIS-Based Assessment of Glacial Lake Outburst Flood (GLOF) Hazards in the Kanchenjunga Conservation Area	Prabish Khadka Chhetri Saeideh Gharehchahi	Jacksonville State University Jacksonville State University
11:00	Long-term, Large-scale Human Influences on the Spatial and Functional Persistence of a Threatened Pine Savanna Ecosystem	John Kupfer Lilian Hutchens Peng Gao Georgina Sanchez	University of South Carolina North Carolina State University University of North Carolina, Wilmington North Carolina State University
11:20	Finding the Forest: Tracing abundance through photographs	Claire Hilbrecht	University of Kentucky
11:40	21st-century droughts are different: Increasing radial growth in old-growth high-elevation conifers in southern California, USA during the exceptional “hot drought” of 2000–2020	Paul Knapp Peter Soule' Tyler Mitchell Avery Catherwood Hunter Lewis	University of North Carolina, Greensboro Appalachian State University University of North Carolina, Greensboro University of North Carolina, Greensboro University of North Carolina, Greensboro

SPECIAL PAPER SESSION

Location: Brandon A

Graduate Honors Student Paper Competition (Masters)

Sponsor: Honors Committee

Co-Chairs: Michele Abee and Joyce Clapp

10:00	Extension Rates of Valley-floor Gullies and the Enhancement of Connectivity in a Southern Piedmont Watershed	Alexis Doren UNC Greensboro	University of North Carolina, Greensboro
10:15	Air Passenger Demand and Metropolitan Economies: Key Predictors in the Pandemic Era	Natsuko Baba	University of North Carolina, Greensboro
10:30	Examining Machine and Deep Learning Techniques to Predict Almond Crop Locations in Central Valley California Using Remote Sensing Technologies	Mashoukur Rahaman	University of Florida
10:45	Extreme Temperature and Adverse Birth Outcomes for Black and White Women in North Carolina from 2011-2020	Bryttani Wooten	The University of North Carolina, Chapel Hill
11:00	Utilizing Spatial Analysis Techniques to Encapsulate the Effects of Sea-level Rise on Coastal Forests and Wetlands in Carteret County, North Carolina	Sarah Radel	North Carolina Central University
11:15	Spatial-temporal analysis of flash floods in Tennessee regions and counties (1996-2022): Identifying trends and emerging hot spots for hazard mitigation and emergency response planning	Emmanuel Afriyie	East Tennessee State University
11:30	Extracting Topography from Historic Maps: Comparing the Effectiveness of Semantic Segmentation Deep Learning and Support Vector Machine	Briar Pierce	University of Florida

PANEL SESSION**Location:** Claremont**Listening session: AAG Mentoring Task Force****Organizer:** Patricia Ehrkamp, AAG Vice President**Chair:** Patricia Ehrkamp, AAG Vice President**Panelists:** Patricia Ehrkamp, University of Kentucky; Selima Sultana, University of North Carolina, Greensboro; Jack Swab, University of Kentucky

Session Description: The AAG Mentoring Task Force is charged with exploring how the AAG can develop and support mentoring structures (such as networks, mentor banks, or mentoring circles), provide guidance on best practices for mentoring, and provide training for mentors. Research shows that effective mentoring has positive outcomes for faculty careers and for careers outside the academy. Mentoring helps early career scholar-educators and aspiring geography practitioners better prepare for and navigate academic and non-academic job markets, and aids in the transition from graduate school to professional careers. Mentoring enhances professional development and provides networking opportunities for early career professionals, supports early career geographers throughout the promotion and tenure process, and is particularly important for those in temporary/precarious positions who often lack institutional support structures. Scholarship on mentoring considers mentoring as 'transformational' and as 'mutually empowering' for mentors and mentees. We are in the process of gathering information about the kinds of support that would be useful for geographers, and we'd love to learn more about experiences, needs, ideas, best practices, and successes. Please come tell us what you need.

12:00 Noon to 1:00 PM**Stand-Alone Geographers (SAGE) Lunch (group members only)**

Merimac

Young Professionals Lunch (group members only)

Monticello

1:00 PM to 3:00 PM**SPECIAL PAPER SESSION****Location:** Eppington**Graduate Honors Student Paper Competition (Undergraduate and PhD)****Sponsor:** Honors Committee**Co-Chairs:** Michele Abee and Joyce Clapp

1:00	Climate Change Influences on Alpine Ice Caves in Tirol Austria	Ryleigh Choplin	Louisiana State University
1:15	Customizing a Resilience Index for Actionable Variables in South Carolina	Margot Habets	University of South Carolina
1:30	Increasing precipitation variability and climate-growth responses of five tree species in North Carolina, USA	Avery Catherwood	University of North Carolina, Greensboro
2:45	"The most radical thing one can do is teach": The Urgency of Bringing Black Geographies Research into K-12 Classrooms	Katrina Stack	University of Tennessee, Knoxville
3:00	Evaluating the Hydrogeomorphological Variations Patterns along the Lower Apalachicola River, Florida	Ali Alruzuq	University of Florida

3:15	Making Health Visible: Social Science, Census Tracts, and the Bounding of Urban Space	Jack Swab	University of Kentucky
------	---	-----------	------------------------

SPECIAL PAPER SESSION

Location: Greenway

Applications in Dendrochronology

Organizer: Carl Jurkowski, University of North Carolina, Chapel Hill, Clay Tucker, University of Southern Mississippi

Chair: Carl Jurkowski, University of North Carolina, Chapel Hill

1:00	Dendrochronological and Foraminiferal Analyses on the Impacts of Saltwater Intrusion on Baldcypress Growth and Mortality in Freshwater Tidal Wetlands Along Smith Creek, NC	Kendra Devereux Monica Rother Andrea Hawkes	University of North Carolina, Wilmington University of North Carolina, Wilmington University of North Carolina, Wilmington
1:20	A Multi-Century Reconstruction of Summer Air Temperatures for the Southeast United States Based on Tree Ring Blue Intensity	Karen King Grant Harley Justin Maxwell Shelly Rayback Stockton Maxwell Matthew Therrell	University of Tennessee, Knoxville University of Idaho Indiana University University of Vermont Radford University University of Alabama
1:40	Exploring Drought Response Across a New Tree Ring Network for the Southeastern, U.S.	Jordan Sharp Maegen Rochner Neil Pederson	University of Louisville University of Louisville Harvard Forest
2:00	Stable Oxygen Isotopes as a Proxy for Climatic Extremes in <i>Taxodium distichum</i> Tree Rings	Jared Friedman Emily Elliott Clay Tucker Matthew Therrell Joshua Bregy Jessie Pearl	The University of Alabama The University of Alabama University of Southern Mississippi The University of Alabama Clemson University The Nature Conservancy
2:20	Exploring the Influence of Sample Preparation and Different Software in Obtaining Blue Intensity Data	Carl Jurkowski Erika Wise	University of North Carolina, Chapel Hill University of North Carolina, Chapel Hill

PAPER SESSION

Location: Riverview

Queer Geographies

Chair: Reagan Yessler, University of Tennessee, Knoxville

1:00	Affinity groups as a site of belonging in professional societies	Nathan Thayer Ashley Dayer Dai Shizuka	Virginia Tech Virginia Tech University of Nebraska, Lincoln
1:20	Landscapes of Fear and Freedom within Tennessee at Yamacon, ETSU-con, and MTAC	Reagan Yessler	University of Tennessee, Knoxville

1:40	A Queer Geography of UW-Madison	Sarah Fogel Brooke Siegel Anika Scholz-Ruf	University of Kentucky University of Wisconsin, Madison University of Wisconsin, Madison
2:00	Futurity or Ontological Annihilation? Queer Politics in the Militarized Landscapes of the Homefront	Nathan McMenamin	University of North Carolina, Greensboro
2:20	“This is Where the Whole World Sees Me”: Indelible Trans Geographies of Louisville, Kentucky	LJ McAllister	University of Kentucky

PAPER SESSION

Location: Montpelier

Transportation Geography

Chair: Tonderai Mushipe, University of North Carolina, Charlotte

1:00	Analysis of Large-scale Brand Networks based on Consumers’ Spatial Shopping Behavior	Debjani Das Liang Mao	University of Florida University of Florida
1:20	Introduction to Mode Choice Accessibility: A Development of New Place-Based Accessibility with a Travel Mode Choice	Kyusik Kim Mark Horner	Florida State University Florida State University
1:40	How do People Travel during Hurricanes? An Exploratory Analysis of Vehicle Trajectories from Hurricane Ian (2022)	Jacob Nchagmado Tagnan Mark Horner Eren Erman Ozguven Onur Alisan Kyusik Kim	Florida State University Florida State University FAMU–FSU College of Engineering FAMU–FSU College of Engineering Florida State University
2:00	Preliminary Mobile Travel Diary in Charlotte, NC	Tonderai Mushipe	University of North Carolina, Charlotte
2:20	Spatial marginalization of emotional support: Understanding public response to animals on airplanes	Aleksandra Craine Ofir Klein	University of Kentucky University of Kentucky
2:40	Improving Bike Share Programs on College Campuses in Southeastern Region of the US: a Case Study	Lord Ebow Sampson Seth Appiah- Opoku	The University of Alabama The University of Alabama

PAPER SESSION

Location: Brandon A

Climate Adaptation

Chair: Jesse Palma, Old Dominion University

1:00	“We Treat Our Water Like Gold”: A feminist political ecology of climate-resilient home gardens in Sri Lanka’s Dry Zone	Nethmi Bathige	University of Kentucky
1:20	Entrepreneurship-based Factors to Support Climate Adaptation Among Indigenous and Local Communities	Indunil Dharmasiri Eranga Galappaththi	Virginia Tech Virginia Tech
1:40	Resilience Planning for Climate-Influenced Hazards and Health Impacts for Virginia Tribes	Nicole Hutton Wie Yusuf Jesse Palma	Old Dominion University Old Dominion University Old Dominion University

2:00	Framing the Intersections of Climate Change and Gender: Exploring NGO Mission Statements in Rural Northern Ghana	Ubaida Abdallah Brian Williams	Mississippi State University Mississippi State University
2:20	Impacts to Local Travel During Weather-Related Road Closures in North Carolina	Julia Cardwell	University of North Carolina, Chapel Hill

PAPER SESSION

Location: Brandon B

Environmental Management Applications

Chair: Johanna Engström, University of Florida

1:00	Security in the coastal zone: Issues & research gaps	Anamaria Bukvic Olga Wilhelmi	Virginia Tech National Center for Atmospheric Research
1:20	What drives wind power development in the United States?	Natalia Dambe Johanna Engström	University of Florida University of Florida
1:40	Community-Based Geospatial Methods: Flood Management and Response in Hopkins, Belize	Laurel Sparks Yasmin Aden Cam Zhen	University of Kentucky Bowdoin College University of Central Florida
2:00	The Past, Present, and Future of Dams in the Southeast U.S.	Johanna Engström	University of Florida

PANEL SESSION

Location: Claremont

Honoring the Life and Legacy of Don Zeigler

Organizer: Jonathan Leib, Old Dominion University

Panelists: Thomas Allen, Old Dominion University; Dawn Drake, University of Oklahoma; Stan Brunn, University of Kentucky; and Georgeanne Hribar, Old Dominion University

Session Description: This session remembers and honors the life and legacy of Dr. Don Zeigler, emeritus professor of geography, who passed away in March 2023 after completing his thirty-six year career at Old Dominion University. Dr. Zeigler was a leading light in the field of geography education having served as President of NCGE, Chief Reader for AP Human Geography, President of GTU, and was a two-time AAG award winner for his work in geography education. The panelists offer brief remembrances of Don and his lasting contribution to geography and geography education. Audience members are also given time to discuss Don's influence and legacy on geography and geography education.

3:10 PM to 5:10 PM

SPECIAL PAPER SESSION

Location: Eppington

Conservation Challenges in Africa: Governance, Land-use/Land Cover Change, and Livelihoods

Organizer: Audrey Culver Smith, University of Florida

Co- Audrey Culver Smith, University of Florida

Chairs: Tierney Shimansky, University of Florida
Aaron King, University of Florida

3:10	Institutional Impact on Namibia's Diverse Vegetation: A Two-Decade Trend Analysis	Anusha Chaudhary	University of Florida
3:30	Exploring the Intersection of People, Wildlife, and Governance: Insights from the Development of a Household-Level Survey in Namibian Conservatories	Tierney Shimansky	University of Florida
3:50	Measuring Participatory Governance in Community-Based Natural Resource Management	Aaron King	University of Florida
4:10	Agro-industrial Land Investments in Africa: Tradeoffs Between Food Production and Forest Conservation in Ethiopia	Audrey Culver Smith	University of Florida

PANEL SESSION

IDEAL Committee

Location: Claremont

Organizers: Michele Abee, Bellarmine University and Joyce Clapp, University of North Carolina, Greensboro

Co-Chairs: Michele Abee, Bellarmine University and Joyce Clapp, University of North Carolina, Greensboro

Panelists: Zainab Ali, University of Florida; Gabriela Hamerlinck, University of Florida; Debs (Debarhana) Ghosh, AAG Council Liaison to JEDI Committee; Patricia Ehrkamp, AAG Vice President

Panel Description: In today's rapidly changing world, the pursuit of IDEAL values unfolds in complex, challenging, and contested spaces. Join the IDEAL committee and guests as they discuss their experiences and share their knowledge, tools, and inspiration as we collectively discuss how to continue these vital efforts.

PAPER SESSION

Placemaking and Sport Geography

Location: Riverview

Chair: Andy Walter, University of West Georgia

3:10	Building Ecology: Strategies to examine placemaking in a shared indoor environment	Timothy Baird Thomas Pingel Shashank Karki Addison Flack Elif Tural Nicole Abaid David Franusich David Kniola Tanner Upthegrove	Virginia Tech Binghamton University Virginia Tech Virginia Tech Virginia Tech Virginia Tech Virginia Tech Virginia Tech Virginia Tech
3:30	Mobilizing and Placemaking: Responses to Sacrifice and Erasure in Coal Communities	Mary Finley-Brook	University of Richmond
3:50	Something Lost: Place, Iconography, and the Logos of Meaning in Minor League Baseball	Dennis Edgell Christopher Green	University of North Carolina, Pembroke University of North Carolina, Pembroke
4:10	Geographies of "Stadium Games": Trends in North American Stadium Locations and Developments.	Andy Walter	University of West Georgia

4:30	Examining Self-Sufficiency through the Lens of Afghan Refugees	Rachel Curtis	Elon University
------	--	---------------	-----------------

PAPER SESSION

Location: Montpelier

Landscapes and Media

Chair: Stephen Birdsall, University of North Carolina, Chapel Hill

3:10	Advertising, Space, and the Measurement of Attention	Jacob Saindon	University of Kentucky
3:30	Realities of Laurel: Depictions of Place on HGTV's Hometown	Caleb Smith	Jones College
3:50	Blockchain Urbanism: Evolving Geographies of Libertarian Exit and Technopolitical Failure	Casey Lynch Àlex Muñoz Viso	University of Twente University of Kentucky
4:10	Is What You See Truly What You Get?	Stephen Birdsall	University of North Carolina, Chapel Hill
4:30	Rye, Roofs and Rolls: A grass's role in the Material and Food Cultures of Kosovo and Albania.	Maria Fadiman Avni Hajdari Andrea Pieroni Bardhë Kurti Xhavit Mala Ardit Hasani Mimozë Buzhala Dafinë Syla Cassandra Quave	Florida Atlantic University University of Prishtina University of Gastronomic Sciences University of Prishtina University of Prishtina University of Prishtina University of Prishtina University of Prishtina Emory University

PAPER SESSION

Location: Brandon A

Geography and Education

Chair: Caitie Finlayson, University of Mary Washington

3:10	Alabama Education: A Geospatial Approach to Education Funding	Cody McGee	Jacksonville State University
3:30	Geography Unbound: Advancing Inclusion and Access Through Open Publishing	Caitie Finlayson	University of Mary Washington
3:50	Changing the Content of Human Geography	David Dorrell	Georgia Gwinnett College
4:10	Making a market for campus investments: The UKInvests program and financial citizenship	Jed DeBruin Michael McCannless Jacob Saindon Jack Swab	University of Kentucky University of Kentucky University of Kentucky University of Kentucky

PAPER SESSION

Location: Brandon B

Physical Geography

Chair: Phillip Schmutz, University of West Florida

3:10	Estimation of Chlorophyll-a in Uncrewed Aircraft System's Imagery using Autonomous Surface Vessel	Mohammad Shakiul Islam	Mississippi State University
------	---	------------------------	------------------------------

	Data by employing Machine Learning Algorithms and Innovative Feature Selection Approaches	Padmanava Dash Abdusalam Nur Hafez Ahmad Rajendra M. Panda Jessica Wolfe Gray Turnage Lee Hathcock Gary Chesser, Jr. Robert Moorhead	Mississippi State University Mississippi State University Mississippi State University Mississippi State University Mississippi State University Mississippi State University Mississippi State University Mississippi State University Mississippi State University
3:30	Mapping the tidal marshes of coastal Virginia: A hierarchical transfer learning approach	Zhonghui Lv Ethan Brewer Karinna Nunez Dan Runfola	College of William and Mary New York University Virginia Institute of Marine Science College of William and Mary
3:50	Examining the effects of Morphological Changes to Sea Turtle Nesting Beaches Using Historical LiDAR Data on Santa Rosa Island to Perdido Key FL	Divina Cox Phillip Schmutz	University of West Florida University of West Florida
4:10	Geophysical Characterization of Submarine Groundwater Discharge in Florida Bay	Ifeanyi Eze Jacque L. Kelly	Georgia Southern University Georgia Southern University
4:30	Reconstruction of Fluvial Geomorphology of the South Fork Holston River Using Freshwater Mussel Assemblages	Ash Keenan	East Tennessee State University
4:50	Assessment of Heavy Metal Concentration in Sediments from the Mobile River, Alabama	Bright Nyameasem Johan Liebens	University of West Florida University of West Florida

5:00 PM to 6:00 PM

SEDAAG Business Meeting	Monticello
--------------------------------	------------

6:00 PM to 7:15 PM

World Geography Bowl Championship	Poplar/Providence
--	-------------------

7:30 PM to 9:30 PM

Honors Banquet and Plenary Address	York/Stratford
---	----------------

VENUE FLOOR PLANS

LOBBY LEVEL

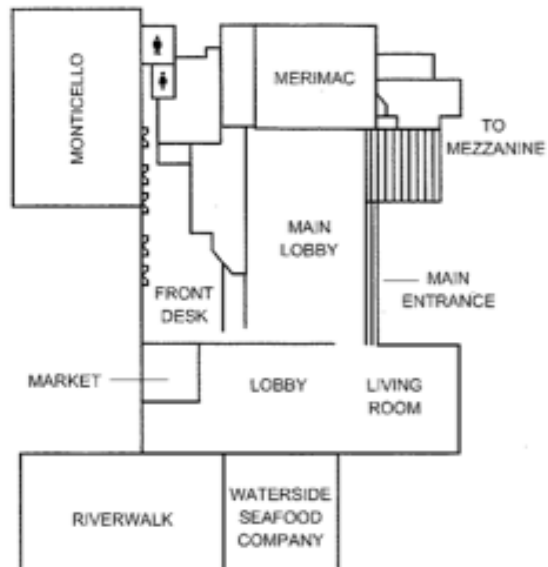

3RD FLOOR

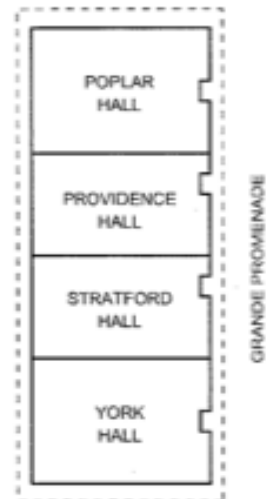

THE INTERNATIONAL BALLROOM
IS DIVISIBLE INTO 4 SECTIONS

4TH FLOOR

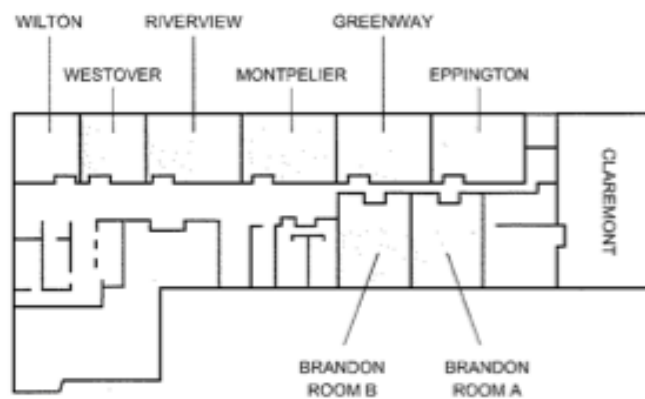

COVID-19 MITIGATION

SEDAAG *highly encourages* the use of masks in public spaces regardless of vaccination status. We are committed to protecting public health and will follow all safety measures based on the guidelines from the Centers for Disease Control and hotel requirements. We continue to monitor changes and will post or announce updates related to the impact of COVID-19.

EVENT CONDUCT POLICY

Professional ideas and information are exchanged most effectively at the SEDAAG Annual Meeting and other SEDAAG events in an atmosphere free of discrimination or harassment and characterized by courtesy and respect. To that end, the SEDAAG expects all individuals who attend the regional conference or who participate in other SEDAAG-sponsored events to conduct themselves in a manner that establishes an atmosphere free from discriminatory practices. All participants are expected to treat others with respect and consideration, follow venue rules, and alert staff or security when they have knowledge of dangerous situations, violations of this Event Conduct Policy, or individuals in distress. This Conduct Policy applies to all attendees and participants at any SEDAAG-sponsored event, including in online venues, and at SEDAAG-sponsored meeting social events. All who register to participate, attend, speak at, or exhibit at an SEDAAG event agree to comply with this Policy.

NOTES:

