

**PROGRAM**  
**77<sup>th</sup> Annual Meeting**  
**of the Southeastern Division of the AAG**



**Hosted by**  
**Columbus State University,**  
**University of West Georgia,**  
**Georgia State University,**  
**and Kennesaw State University**  
**November 20-21, 2022**  
**Atlanta, Georgia**



## **SEDAAG Executive Committee**

**President** Bill Graves, UNC Charlotte

**Vice President** Jennifer Rahn, Samford University

**Secretary** Craig Ramseyer, Virginia Tech

**Treasurer** Paul McDaniel, Kennesaw State University

**Past President** Lynn Resler, Virginia Tech

**Regional Councilor** Selima Sultana, UNC Greensboro

## **SEDAAG Steering Committee**

**Members of the Executive Committee** (see above)

**Editors, *Southeastern Geographer*** Selima Sultana & Paul Knapp, UNC Greensboro

**Alabama State Representative** Jordan Cissell, Samford University

**Florida State Representative** Johanna Engström, University of Florida

**Georgia State Representative** Eric Spears, Columbus State University

**Kentucky State Representative** Michele Abee, Bellarmine University

**Mississippi State Representative** Brian Williams, Mississippi State University

**North Carolina State Representative** Sarah Praskievicz, UNC Greensboro

**South Carolina State Representative** Dean Hardy, University of South Carolina

**Tennessee State Representative** Ingrid Luffman, East Tennessee State University

**Virginia State Representative** Anamaria Bukvic, Virginia Tech

**West Virginia State Representative** Tom Saladyga, Concord University

**Student representative to the Steering Committee** Stephanie Insalaco - University of Tennessee

## **2021 SEDAAG Program Committee**

**Program Chair** Jennifer Rahn, Samford University

**Members** SEDAAG Executive Committee

## **2021 SEDAAG Local Arrangements Committee**

**Program Chair** Eric Spears, Columbus State University

## **Officers, American Association of Geographers**

**President** Marilyn Raphael, UCLA Department of Geography

**Vice President** Rebecca Lave, Indiana University

**Secretary** Joseph Oppong, University of North Texas

**Treasurer** Marcia England, Miami University

**Past President** Emily Yeh, University of Colorado Boulder

**Executive Director** Gary Langham, American Association of Geographers

**Southeastern Regional Division Councilor** Selima Sultana, UNC Greensboro

# SEDAAG Honors Committee

**Chair** Phillip Schmutz, University of West Florida

**Committee Members** Jonathan Fleming, Samford University; Stockton Maxwell, Radford University; Michele Abee, Bellarmine University; Joyce Clapp, UNC Greensboro.

## World Geography Bowl Committee

**Event Organizers:** Dawn M. Drake, Tom Bell, Ethan Bottone, Jamison Conley, Dennis Edgell, Peggy Gripshover, Jeff Neff, Lee Ann Nolan, Michael Pretes, and Caleb Smith

**Moderators:** Dawn Bowen, Tom Bell, Paul McDaniel, Amy Potter

**Judges:** Jesse Andrews, Shane Canup, Peggy Gripshover, Christa Smith

**Scorekeepers:** Ethan Bottone, Jamison Conley, Ingrid Luffman, and Mark Sciuchetti

**Master Scorekeeper** Lee Ann Nolan

### Team Coordinators:

**Florida:** Jason Ortegren, University of West Florida

**Georgia:** Amy Potter, Georgia Southern University

**Kentucky:** Jack Swab, University of Kentucky

**Tennessee:** Wil Tolefson, East Tennessee State University

**Virginia:** Dawn Bowen and Joe Nichols, University of Mary Washington

### Finals Round Volunteers

**Moderator:** Dawn M. Drake

**Scorekeeper:** Lee Ann Nolan

**Judges:** Shane Canup and Ingrid Luffman

### Dream Team

Marilyn Raphael, AAG President, UCLA

Bill Graves, SEDAAG President, University of North Carolina - Charlotte

Jamison Conley, Director of AAG World Geography Bowl, West Virginia University

Andy Walter, 2022 Organizing Committee, University of West Georgia

Jonathan Leib, 2023 Organizing Committee, Old Dominion University

# PROGRAM AT A GLANCE

<b>Sat. Nov. 19</b>	<b>Executive Committee Meeting</b>	<b>5:00 - 7:00 PM</b> (Conference 4)
---------------------	------------------------------------	--------------------------------------

<b>Sunday, Nov. 20</b>		
<b>TIME</b>	<b>EVENT</b>	<b>LOCATION</b>
8 AM – 7 PM	<b>Registration is open all day</b>	Conference 1 Foyer
8:30 - 11:00	<b>Steering Committee Meeting &amp; Breakfast</b>	Private Room 1 (Restaurant)
11:00 - 11:45	<b>World Geography Bowl Registration</b>	Salon 1,2,3
11:45	<b>World Geography Bowl Orientation</b>	Salon 1,2,3
12:00 - 3:30	<b>World Geography Bowl Round Robin Competition</b> (winning teams and all-star team announced immediately following conclusion of Round Robin Competition)	Salon 1,2,3 / Conference C, D, E, 5
3:00 – 4:00	<b><i>Southeastern Geographer</i> Social Event</b>	Conference 4
4:00 - 6:00	<b>Paper and Poster Sessions</b>	See Program
6:30 – 7:30	<b>Welcoming Reception</b>	Grand Ballroom Foyer

<b>Monday, Nov. 21</b>		
<b>TIME</b>	<b>EVENT</b>	<b>LOCATION</b>
7 AM - 1 PM	<b>Registration</b>	Conference 1 Foyer
7:00 - 8:00	<b>Status of Women in Geography Breakfast</b> (group members only)	Private Room 1 (Restaurant)
7:50 - 5:10	<b>Paper, Poster, and Panel Sessions</b>	See Program
8:00 - 5:00	<b>Southeastern Geographer Photo Competition</b>	Foyer by Registration
12:00 – 1:00	<b>Stand-Alone Geographers (SAGE) Lunch</b> (group members only)	Private Room 1 (Restaurant)
5:00 - 6:00	<b>SEDAAG Business Meeting</b>	Conference B
6:00 - 7:15	<b>World Geography Bowl Championship</b>	Salon 1,2,3
7:30 - 9:30	<b>Honors Banquet and Plenary Address</b>	Salon 4, 5, 6

## 3:00pm – 4:00pm

### ***Southeastern Geographer Social Event***

Conference 2

## 4:00pm - 6:00pm

### **Student Honors Posters**

#### POSTER SESSION

**Location:** Conference A

#### **Graduate Honors Student Poster Competition**

**Organizers:** Sponsored by the SEDAAAG Honors Committee

**Chair:** Phillip Schmutz

<i>Are Some Cities Tornado Magnets?</i>	Cooper Corey	The University of Alabama
<i>The Influence of Urban Forms and Street Infrastructure on Pedestrian-Motorist Collisions</i>	Taylor Foreman	Georgia Southern University
<i>Where are Electric Vehicles? Spatial Mismatch between AFV and EJ in Maryland</i>	Sheila Jebiwot	UNC Greensboro
<i>Utilizing Spatial Analysis Techniques to Encapsulate the Effects of Sea-Level Rise on Coastal Forests in Carteret County, North Carolina</i>	Sarah Radel	North Carolina Central University

#### POSTER SESSION

**Location:** Conference A

#### **Undergraduate Student Poster Competition**

**Organizers:** Sponsored by the SEDAAAG Education Committee

**Chair:** Jonathan Fleming and Jennifer Rahn

<i>Uncovering the effects of climate change on the food system in South Carolina</i>	Katie Militello	Furman University
<i>A GIS based Automated Mapping of Greenville's Heritage Trees and Potential Applications</i>	Jack Buehner	Furman University
<i>Vegetative Succession using GIS and Remote Sensing on the March 2021 EF3 Tornado in Central Alabama</i>	Samantha Gamble	Samford University
<i>Drinking Water Violations in the Mountain State: Patterns and Trends Before and During COVID</i>	Alexis Foster	Concord University
<i>Towards a Climatology of Rapid Visibility Reductions in Heavy Snowfall</i>	Ella Hunter	University of Tenn, Knoxville
<i>That's how gentrification has rolled out:" A GIS Analysis of Neighborhood Change Around Philadelphia Black History Museums</i>	Rebecca Neely	Georgia Southern University

4:00pm - 6:00pm

## Undergraduate Student Posters

### POSTER SESSION

Location: Conference A

### Undergraduate Student Posters

<i>A Comparison of Forest Dynamics at Two Sites in Southwestern Virginia</i>	Savannah Trail and Stockton Maxwell	Radford University
<i>A multifactor assessment for determining impacts of anthropogenic noise across rural landscapes in Upstate South Carolina</i>	Katherine Irsik, Bryce DelaCourt, Jake Gerardi, and John Quinn	Furman University
<i>Archaeological Investigations at Bains Gap, Northeastern Alabama: Then &amp; Now</i>	Tyler McKee, Kathryn Catlin, Olivia Conner, Harry Holstein, Summer Kiker, and Austin Turner	Jacksonville State University
<i>Assessment of Lichen Abundance as an Indicator of Air Pollution</i>	Justin Rahn	University of West Florida
<i>Climate Change, Flooding Impacts, and Resilience in Bucksport, South Carolina</i>	John Roper and Geoffrey Habron	Furman University
<i>Decolonizing Food Systems in Costa Rica through Agroecology Principles</i>	Maggie Atchley and Karen Allen	Furman University
<i>Destruction of Vegetation along the Qinghai-Tibet Railway</i>	Yifeng Huang	Yifeng Huang
<i>Don't Sweat It: An Exploration of Effective Heat Risk Communication to Youth</i>	Marissa Pickett and Sophia Roberts Alisa Hass	Middle Tenn. State University Pacific University
<i>Ecosystem Services and Environmental Policy: An analysis of PES contracts in the Bellbird Biological Corridor, Costa Rica</i>	Chloe Sandifer-Stech, Karen Allen, and John Quinn	Furman University
<i>Exploratory Use of Traffic Accident Data to Measure COVID-19 Related Changes in Mobility and Driver Behavior in Atlanta, Georgia</i>	Laurel Sparks	Georgia State University
<i>Exploring the Dendrochronological Potential of Eastern Red Cedar Trees at the McGhee-Carson site, Vonore, Tennessee</i>	Madlen Conley and Matthew Kerr Lauren Baghetti Jacqueline Kerr	University of Tennessee Tennessee State Parks University of Tennessee
<i>Flooding Changes Communities</i>	Finn Gillette and Maritza Mazariago	Coastal Carolina University
<i>GIS Analysis of Aythya baeri Habitat in China</i>	Guhao Qin and Jina Chne	University of North Alabama
<i>GIS Applications in Carceral Data</i>	Derrick Tilley	University of North Alabama
<i>GIS based Land Suitability Analysis for Sustainable Agricultural Production at Friendship Farms</i>	Dylan Stout and Andrew Foy	Radford University

<i>Growth-Climate Relations of Bertholletia excelsa growing in Southeastern Peru</i>	Jonathan Antin, Lucas White, and Stockton Maxwell	Radford University
<i>Has COVID-19 Migration Caused Land Cover Change in the State of California?</i>	Kashayla Garcia and Meimei Lin	Georgia Southern University
<i>New Proxy Evidence of Prehistoric Agriculture and Environmental Change at Laguna Bonilla, Costa Rica</i>	Mason McVey and Sally Horn	University of Tenn. Knoxville
<i>Remote Sensing of water quality monitoring in Okeechobee in Florida</i>	Yuntian Xue and Sunhui Sim	University of North Alabama
<i>Smartphone or Handheld GNSS? A comparison of absolute/relative accuracy of a Garmin eTrex 20x to a variety of smartphone models</i>	Sonrisa Reed and Jacob Bateman McDonald	University of North Georgia
<i>Spatio-temporal Modelling of Air Pollution in Alabama</i>	Timothy Gaskins and Saeideh Gharehchahi	Jacksonville State University
<i>The Difference in Air Quality before and after COVID-19 in the US</i>	Fu Li	University of North Alabama
<i>Toxic Air Pollution in Louisiana</i>	Cassidy Bolt	Jacksonville State University
<i>University of West Florida Campus Ecosystem Study: using dendrochronology to analyse tree growth of longleaf pines</i>	Heather Patten, Sarah Rabinowitz, and Frank Gilliam	University of West Florida
<i>Why Grow Green? The Values Informing Agroecology in Costa Rica</i>	Julia McCabe	Furman University

**4:00pm - 6:00pm**

## Paper Sessions

**SPECIAL PAPER SESSION**

**Location:** Salon 1, 2, & 3

### Memory-Work I: The Politics and Implications of Truth-Telling

**Organizers:** Derek H. Alderman, University of Tennessee

Rebecca Sheehan, Oklahoma State University

**Chair:** Derek H. Alderman, University of Tennessee

**Session description:** Communities inside and outside of the Southeast US are increasingly engaged in memory-work, which is the politics and processes of remembering and recovering from the wounds of racialized violence, inequality and exclusion. This memory-work refers to a broad range of social actors, practices, and places associated with coming to terms with these painful legacies, removing oppressive commemorative structures, as well as creating new memorial forms that open up opportunities for racial reconciliation and for marginalized groups, in particular communities of color, to assert their rights and legitimacy. Memory-work is an important analytical lens for understanding the complexities and challenges of this memory-justice nexus while also providing scholars an ethical framework for guiding their publicly-engaged research and the solidarity and support they lend to reparative memory projects. In this first of two special sessions, established and emerging voices in the geographical study of memory-work come together to address the contested politics and implications of truth-telling about enslaved labor, racialized lynching, the Confederacy, and long-held traditions of erasing Black memory.



4:00	<i>The Modern Infrastructure Landscape and the Legacy of Slavery</i>	Joshua F.J. Inwood	Penn State University
4:20	<i>"The Best of Who We are and Where We Want to Go": When Memory Work and Urban Redevelopment Collide</i>	Jennifer Speights-Binet	Samford University
4:40	<i>The Politics of Remembering through Policy and Its Uneven Enforcement: Confederate Commemoration at Gettysburg</i>	Katrina Stack Rebecca Sheehan	University of Tennessee Oklahoma State University
5:00	<i>"This road always brings back memories:" Creating Tybee Island, Georgia's Black History Trail</i>	Amy Potter Joyah Mitchell	Georgia Southern University Georgia Southern University
5:20	<i>Contesting a "Tiny" Actant: Complicating the Capacity of Soil Collection at Lynching Sites for Regenerative Memory-Work</i>	Rebecca Sheehan	Oklahoma State University

#### PAPER SESSION

**Location:** Conference 8

#### Protected Areas of the Southeast

**Chair:** John Kupfer

4:00	<i>Coastal Hazards and Resilience at Cape Hatteras National Seashore</i>	Thomas Allen	Old Dominion University
4:20	<i>Underrepresentation of Black Visitors in Great Smoky Mountains National Park: Evidence from Household Survey Data</i>	Selima Sultana	UNC Greensboro
4:40	<i>The lost Southeastern roadside national park units and the Army's national park system</i>	Joe Weber	University of Alabama
5:00	<i>Using mobile device data to track the effects of the COVID-19 pandemic on spatiotemporal patterns of national park visitation</i>	John Kupfer and Zhenlong Li Huan Ning Xiao Huang	University of South Carolina University of South Carolina University of Arkansas
5:20	<i>Sense of Place and the Redesignation of the Gateway Arch National Park</i>	Seth Kennarr	University of Tennessee / University of Missouri
5:40	<i>A Spatially Explicit Machine Learning Model for Visit Prediction to Georgia Recreational Vehicle Parks at the Census Block Group Level</i>	Nemin Wu Shelley Welton Gengchen Mai	University of Georgia University of Pennsylvania University of Georgia

**PAPER SESSION****Location:** Conference 6**Networks, Neighborhoods & New Geographies****Chair:** Ted Goudge

4:00	<i>The American Game: The Geography of College Football Player Production and Program Success, 2021</i>	Ted Goudge	NW State University
4:20	<i>Quantifying value of ecotourism using social networking sites</i>	Kayla Stan	University of Southern Mississippi
4:40	<i>GIS, Marketing, and Nonprofits: How to Leverage GIS Assets in a Community to Support Nonprofit Growth and Student Engagement</i>	Mark Sciuchetti and Jianping Huang	Jacksonville State University
5:00	<i>Military Pasts, City Futures: The Transition of Brooks, San Antonio from Military Base to a Peri-Urban Mixed-Use Development</i>	Michelle Padley	UNC
5:20	<i>Participatory Mapping to Address Neighborhood Level Data Deficiencies for Food Security Assessment in Southeastern Virginia, USA</i>	Nicole Hutton George McLeod Thomas Allen Christopher Davis	Old Dominion University Old Dominion University Old Dominion University Old Dominion University
5:40	<i>Mapping the Black Creek Trail System at Noccalula Falls Park and Campground in Gadsden, Alabama using ArcGIS Software and Applications</i>	Margaret Walton	Jacksonville State University

**PAPER SESSION****Location:** Conference B**Critical Geographies of Climate Change & Conservation****Chair:**

4:00	<i>De-naturalizing the Landscape: Or how states shift the risk of harm to individuals in a post-conflict space</i>	Ruth Trumble	University of Wisconsin-Madison
4:20	<i>Tortoises to Acres: Property as a conservation strategy and more-than-human life in expressway decision-making processes</i>	Caitlin Jones	Florida State University
4:40	<i>Snapshot of a Crisis: Food Security and Dietary Diversity Levels among Disrupted Conventional and Long-Term Organic Tea-Smallholders in Sri Lanka</i>	Nethmi Bathige	University of Kentucky
5:00	<i>Ecology, Migration, and the Settler Colonial State: How Science and Conservation Reinforce the U.S.-Mexico Border Wall in the Lower Rio Grande Valley</i>	Rachel Arney	University of Georgia
5:20	<i>Climate Change Adaptation Services: Applications from the Global Environmental Facility</i>	Helen Rosko Ed Carr Virginia Gorsevski	Georgia Southern University Clark University Global Environment Facility
5:40	<i>Interdisciplinary Collaboration &amp; Pedagogy at the Bains Gap Village Site, Alabama</i>	Kathryn Catlin, Harry Holstein, Mark Sciuchetti, Sean Chenoweth, and Dana Herren	Jacksonville State University

**PAPER SESSION****Location:** Conference C**Geospatial Methods I****Chair:** Carol Samuelson

4:00	<i>Comparison of RTK Relative Elevations between Utility Vehicle collected points and an sUAS collected photogrammetric surface of a cotton field in Eastern Arkansas.</i>	Richard Pickett John Nowlin Ahmed Hashem Joseph Massey Michele Reba	Arkansas State University Arkansas State University Arkansas State University USDA USDA
4:20	<i>HBIM AND GIS INTEGRATION: A Case Study of historic Coby Hall on the campus of the University of North Alabama</i>	Carol Samuelson	University of North Alabama
4:40	<i>Calculating and Pivoting a Place-Based Food Price Index with Tapestry Segmentation</i>	Lan Mu Chen Zhen Brian Duran Chandra Dhakal	University of Georgia
5:00	<i>GIS Terrain Analysis for Flight Planning</i>	Marin Yang Han Li Godfrey D'souza	University of Miami University of Miami Embry-Riddle
5:20	<i>Change detection of Urban footprint in Atlanta City</i>	Wenjie Zhao Sunhui Sim	University of North Alabama University of North Alabama
5:40	<i>The Evolution of Georgia Counties</i>	David Dorrell	Georgia Gwinnett College

**4:00 pm - 6:00pm****Panel Session****PANEL SESSION****Location:** Conference 7**Teaching Introductory Level Human/World Geography Courses: Best Practices and Reflections****Organizer:** Caroline McClure, Georgia State University**Sponsor:** SEDAG Education Committee**Chair:** Caroline McClure, Georgia State University**Panelists:** Jordan Cissell, Samford University, Caroline McClure, Georgia State University,

Jared Margulies, University of Alabama

**Session Description:** Many early-career faculty in Geography and Geoscience departments are placed in a classroom teaching human geography or world regional geography at the introductory level, with or without prior teaching experience. Many graduate students are lucky enough to get teaching experience in these types of classes, many do not until they are in their first academic position (TT or NTT). This session will compare practices and discuss methods for teaching such courses. It will bring together a diverse group of faculty, all currently teaching a human or world geography style introductory course. The participants will share their experience teaching the course, their format for the course, and what does and does not work in the classroom (projects vs. exams, textbook choices, modality – face-to-face, hybrid, online asynchronous or synchronous, field studies, etc.). Anyone interested is invited to also share their experiences in teaching the course, along with ideas on how to give students the best experience concerning learning this type of content.

6:00pm – 7:30 pm

Welcome Reception

Grand Ballroom Foyer

## Paper, Panel and Poster Sessions

Each paper time slot is 20 minutes long: 15 minutes for the paper presentation followed by 5 minutes of audience/presenter discussion. Please respect the chairperson's time cues.

Monday

November 21

7:00am – 7:50am

Status of Women in Geography Breakfast *(group members only)*

Private Room 1 (Restaurant)

7:50am – 9:50am

SPECIAL PAPER SESSION

Location: Salon 1, 2, & 3

### Innovations in Economic Geography

Organizer: Ron Kalafsky, University of Tennessee

Chair: Ron Kalafsky, University of Tennessee

7:50	<i>The Foreign-Trade Zone in Mobile, Alabama and its Impact on Neighboring Communities</i>	Jesse Lane	NW Missouri State University
8:10	<i>Export Geographies of Smaller Southern MSAs: Trajectories and Changes</i>	Ron Kalafsky	University of Tennessee
8:30	<i>Graduate migration and city preferences: A multi-wave experimental approach to university student migration decision-making</i>	Michael Ewers	UNC-Charlotte
8:50	<i>City as Production Space: Pandemic Era Business District Evolution in Secondary Urban Centers</i>	William Graves Chuck McShane Jonathan Kozar	UNC-Charlotte CoStar Group Marshall University
9:10	<i>Scenes Along Chessie's Road: Place Imagery in Chesapeake and Ohio Railway Advertising</i>	Craig Laing	UT Chattanooga
9:30	<i>Responding to Global Food Shortages Through Innovation</i>	Dawn Drake	Missouri Western State University

**PAPER SESSION****Location:** Conference C**Racism, Agri-food Regimes, and Justice in the U.S. South****Organizers:** Alex Moulton, University of Tennessee, Brian Williams, Mississippi State University**Chair:** Brian Williams, Mississippi State University**Session description**

In the past two decades, attempts by Black, Native, and Latinx farmers to counter systematic exclusion from agricultural assistance by federal agencies such as the USDA have been curtailed by opposition from primarily white agro-industrial lobby groups and limited political will. Concrete measures to address ongoing historical injustices in agriculture have often been derided as ‘reparations’ and reverse racism, yet racism in agriculture has been central to the precipitous decline of farmers in America (Orozco et al. 2018; Graddy-Lovelace 2017; Wright et al. 2020). Policies that benefit large-scale white farms and agro-industry at the expense of agricultural workers and small-scale farmers have been structured by racism in inception and implementation and have contributed to the disinvestment and depopulation of rural landscapes (Williams & Freshour 2022). Although such policies have often been advocated in the name of agricultural productivity and “food security”, food apartheid as Karen Washington describes it (Brones 2018) continues to undermine foodways and abundance in urban and rural contexts alike. However, there is a rich tradition of work and organizing in the South that has confronted agri-food injustice and nurtured alternatives. From the cooperative development strategies of Black farmers to Fannie Lou Hamer’s work to build spaces free from agrarian oppression (Alkon and Mares 2012; Grant et al. 2012; McCutcheon 2019; White 2018), abundance in the South has been continuously cultivated through visions and practices that challenge and seek to supplant the violent rationalities of dominant agri-food regimes (Woods 2017). This session features work that examines how racism shapes the political economy and ecologies of southern food and agriculture, alongside papers that highlight the work of food justice, environmental justice, and land justice in southern agri-food systems.

7:50	<i>From Free Soil to Dispossession: Cotton Interests and Emancipation</i>	Erna DuPuis	Pace University
8:10	<i>Black Small-Scale Farmers in Mississippi: Hardships and Resiliency Strategies</i>	Destiny Crockett	Mississippi State University
8:30	<i>‘So God Made a Farmer’: Media, Misrepresentations and the Crafting of Agricultural Imaginations.</i>	Willie Wright	University of Florida
8:50	<i>Black Food Geographies in the Mississippi Delta.</i>	Taylor Patterson	Mississippi State University
9:10	<i>Hunger and Help: The Role of SNAP and Food Banks in the U.S. South</i>	Maya Rao	University of Georgia
9:30	<i>Sifting Through the Past: Black Farming Archives in Appalachian Kentucky</i>	Jed DeBruin	University of Kentucky

**PAPER SESSION****Location:** Conference D**Geospatial Methods II****Chair:** Jacob Bateman McDonald

7:50	<i>Multivariate Hydraulic Geometry Equations for the Southern Blue Ridge Mountains of western North Carolina</i>	Jacob Bateman McDonald David Leigh	University of North Georgia University of Georgia
8:10	<i>Spatiotemporal Optimization for the Placement of Automated External Defibrillators</i>	Jielu Zhang Lan Mu Donglan Zhang	University of Georgia University of Georgia New York University

8:30	<i>Development of a Method to Summarize Metropolitan Traffic Amount</i>	Jeong Seong Yunsik Kim Hyewon Goh Ana Stanescu	University of West Georgia Dongguk University Chonnam University University of West Georgia
8:50	<i>Kudzu mapping using phenology and spectral unmixing of multispectral satellite imagery: A case study from Knox County, Tennessee</i>	Ming Shen Maofeng Tang Yingkui Li	University of Tennessee University of Tennessee University of Tennessee
9:10	<i>The Precipitation's Influence on Bushfires in Savanna Climate Zone of Northern Territory, Australia</i>	Zhiyi Li Jian Chen	University of North Alabama University of North Alabama
9:30	<i>Remote Sensing and GIS-Based Suitability Mapping of Termite Habitat in the African Savanna: A Case Study of the Lowveld in Kruger National Park</i>	Audrey Smith Emre Özşahin Mehmet Özdeş Di Yang	University of Florida Tekirdag Namik Kemal Uni. Tekirdağ Namuk University University of Wyoming

## PAPER SESSION

**Location:** Conference E

### Geographies of Health I

**Chair:** Korine Kolivras

7:50	<i>A Cross-Sectional Multilevel Analysis of the Impact of Healthcare Access on Drug Overdose Mortality in Appalachian Counties</i>	Nicole Callais Liem Tran	University of Tennessee University of Tennessee
8:10	<i>Variation in Health and Healthcare-Seeking Behavior among the Urban Poor in Dhaka, Bangladesh</i>	Mahjabin Kabir Adrita	Virginia Tech
8:30	<i>The Emerging Threat of Lyme Disease in Appalachia</i>	Korine Kolivras	Virginia Tech
8:50	<i>Spatiotemporal Analysis of COVID-19 in School-Age Children in Tennessee.</i>	Omobolaji Olawuyi Ingrid Luffman	East Tennessee State University East Tennessee State University
9:10	<i>Spatio-Temporal Analysis of COVID-19 between Urban and Rural regions over the course of the Pandemic</i>	Chima Okoli Samuel Akinnusi Timothy Mulrooney Christopher McGinn	North Carolina Central Uni North Carolina Central Uni North Carolina Central Uni North Carolina Central Uni
9:30	<i>Simulating and deploying the upscaled use of a novel silver-ceramic technology to disinfect drinking water in schools in India</i>	Dillon Mungle Luke Juran James Smith Jamie Harris Lalit Sharma	Virginia Tech Virginia Tech University of Virginia University of Virginia S.M. Sehgal Foundation

## PAPER SESSION

**Location:** Conference 6

### Urban Geography I

**Chair:** John Stehlin, University of NC at Greensboro

7:50	<i>Highway removal, racialized inequality, and regional restructuring in the United States</i>	John Stehlin	UNC Greensboro
8:10	<i>The Fight for Energy Justice in Atlanta, Georgia</i>	Nikki Luke	University of Tennessee, Knoxville
8:30	<i>Testing transportation sustainability of new urbanism communities in the Southeastern US</i>	Sunhui Sim	University of North Alabama
8:50	<i>Against (Settler) Colonial Climate Action: A Look into Seattle, Washington's Climate Mitigation Plans</i>	Maya Henderson Jennifer Rice	University of Georgia University of Georgia
9:10	<i>Intown: Remaking the place imaginaries of Atlanta's eastside neighborhoods</i>	Katherine Hankins Kayla Edgett Joseph Pierce	Georgia State University University of Georgia University of Aberdeen

9:30	<i>Environmental injustice and E. coli in the Upper South River watershed</i>	Sarah Ledford Richard Milligan Lacey Davis Jacqueline Echols	Georgia State University Georgia State University Georgia State University South River Watershed Alliance
------	---	---	--

## PANEL SESSION

Location: Conference 7

### Queer Pedagogies: Opportunities and Challenges in the Classroom

**Chair:** Rachael Cofield, Florida State University

**Sponsor:** SEDAG Education Committee

**Panelists:** Rachael Cofield

James Capello

Lex Pulice-Farrow

Vanessa Lacy Raditz

John "Jack" Swab

Florida State University

Savannah College of Arts & Design (SCAD)

University of Tennessee Knoxville

University of Georgia

University of Kentucky

## POSTER SESSION

Location: Conference 4

### Physical Geography Posters

<i>Evaluation of Storm Location and Motion Information in Tornado Warnings for Geospatial Awareness and Decision Support</i>	Kevin Ash Caley Feemster Christopher Williams Jennifer Boehnert Julie Demuth David Gagne Rebecca Morss	University of Florida University of Florida University of Florida Natl Center for Atm Research Natl Center for Atm Research Natl Center for Atm Research Natl Center for Atm Research
<i>Long-Term Ozone Health Analysis of Atlanta Urban Agglomeration of United States Using Machine Learning and Cloud Computing Techniques</i>	Subhasis Ghosh Chandana Mitra Sukanya Dasgupta	Auburn University Auburn University Auburn University
<i>Atlanta: Is It Really a 'City in the Forest'?</i>	Campbell Casseb	Georgia State University
<i>Observations on the Annual Timing of the Last Winter Temperature Occurrence During Spring/Summer Across Florida, 1960 - 2021</i>	Nicole Rusden Jason Ortegren	University of West Florida University of West Florida
<i>Flood risk assessment on critical infrastructure: a case study of road infrastructure in Montgomery County, Maryland.</i>	Zainab Akinsemoyin Munshi Rahman	Georgia Southern University Georgia Southern University
<i>Stable Carbon Isotope Ratios in Lake Sediments as Indicators of Historic Changes in Vegetation and Land Use at Rutland Lake, New York, U.S.A.</i>	Anna LaFollette Sally Horn Chad Lane Roger Brown	The University of Tenn., Knoxville The University of Tenn., Knoxville UNC Wilmington Retired
<i>Comparison of the radial growth patterns of shortleaf pine (Pinus echinata) based on topographic aspect in the Uwharrie Mountains of North Carolina</i>	Hunter Lewis	UNC Greensboro

<i>Comparing Radar Reflectivity Values of Convective and Stratiform Precipitation retrieved from Satellite- and Ground-based Radars in Tropical Cyclones</i>	Zainab Ali Corene Matyas Kimberly Wood Stephanie Zick	University of Florida University of Florida Mississippi State University Virginia Tech
<i>Beach Erosion and Recovery since Hurricane Ivan in 2004 along a Headland-Bay Coast in Treasure Beach, Jamaica</i>	Elandé Engelbrecht Robert Pavlowsky	Missouri State University Missouri State University
<i>Investigating the Influence of Large Wood on Bedform Complexity In Low Gradient Rivers</i>	Derek Martin Sarah Praskievicz Rajesh Sigdel Joshua Platt Stephanie Stephens	Appalachian State University UNC Greensboro UNC Greensboro Appalachian State University UNC Greensboro
<i>Multi-threaded Channel Systems in Karst Headwater Valleys in the Ozark Highlands</i>	Afrida Aranya Joshua Hess Robert Pavlowsky Tasuba Jerin Hannah Lowery	Missouri State University Missouri State University Missouri State University Missouri State University Missouri State University
<i>Headward Erosion Rates and Upland Connection Ages for Three Valley Floor Gullies in the North Carolina Piedmont</i>	Alexis Doren Dan Royal	UNC Greensboro UNC Greensboro
<i>Large Wood Distribution and Influence on Channel Morphology in Headwater Valleys of the Ozark Highlands</i>	Hannah Lowery Joshua Hess Robert Pavlowsky	Missouri State University Missouri State University Missouri State University
<i>Mixed-Pine Tree-Ring Site Chronology and Growth-Climate Relationship for the University of West Florida Campus</i>	Gabe Small Jason Ortegren	University of West Florida University of West Florida
<i>The impacts of projected temperature and precipitation change on crop water availability in Puerto Rico</i>	Flavia Moraes Craig Ramseyer Douglas Gamble esq.	Georgia State University Virginia Tech UNC Wilmington
<i>A Holistic Approach to Analyzing Seagrass and Ecosystem Decline in Mosquito Lagoon, Florida</i>	Stephanie Insalaco	University of Tenn. Knoxville
<i>Post-flood Geomorphic and Vegetative Dynamics on “set-aside” Sandbars on the Missouri River.</i>	Amena Begum Ruma Mark Dixon Mark Sweeney S M Asger Ali	University of South Dakota University of South Dakota University of South Dakota Mississippi State University
<i>Immediate Channel Response to a Dam Removal in Southern Appalachia</i>	Josh Platt Derek Martin Michael Mayfield William Armstrong	Appalachian State University Appalachian State University Appalachian State University Appalachian State University
<i>Impact of Land use and Land cover change on species composition of Malaria vector: A case study of Nzema East, Ekumfi, and Central Tongu Districts, Ghana.</i>	Emmanuel Aklie Essandoh Tinnon S Gharehchahi Khadka Chhetri	Jacksonville State University Jacksonville State University Jacksonville State University Jacksonville State University
<i>Spatial distribution of shallow groundwater salinity in the upper awash river basin aquifer, Ethiopia.</i>	Bewuket Tefera Jane Southworth	University of Florida University of Florida
<i>Using high resolution aerial and satellite imagery to map and examine Georgia tidal freshwater marsh vegetation.</i>	Harrison Currin Christine Hladik	Georgia Southern University Georgia Southern University



## 10:00am - 12:00 noon

### SPECIAL PAPER SESSION

**Location:** Salon 1, 2, & 3

### Graduate Honors Student Paper Competition

**Sponsor:** Honors Committee

**Chair:** Phillip Schmutz

10:00	<i>Landslide susceptibility modeling in Chittagong hill tracts using machine learning and statistical prediction techniques</i>	Mashoukur Rahaman	University of Florida
10:15	<i>Hydrological Drought Forecasting using Deep Transformer Model</i>	Amobichukwu Amanambu	University of Florida
10:30	<i>Evaluating Equity-Focused State Electric Vehicle Charging Station Placement using Accessibility: A Case Study of Raleigh-Durham</i>	Gregory Carlton	UNC Greensboro
10:45	<i>A dendroecological method to examine summertime soil-moisture changes: A case study from North Carolina, USA</i>	Avery Catherwood Tyler Mitchell Paul Knapp	UNC Greensboro
11:00	<i>Urban-Rural Tornado Occurrence in the Midwestern &amp; Southern U.S.</i>	Sarah Jackson	University of South Carolina
11:15	<i>Southern cultural tropes in craft beer naming and image conventions</i>	Joshua Merced	UNC Greensboro
11:30	<i>Automated Technique to Delineate and Quantify Mining Pits and Depressions using Level Set Method (LSM) and Localized Counter Tree (LCT) in the Amite River, Louisiana</i>	Maram Alrehaili	University of Florida
11:45	<i>Large wood loads in urban streams: The role of recruitment limitation versus transport dominance</i>	Rajesh Sigdel	UNC Greensboro

### PAPER SESSION

**Location:** Conference C

### Cyclones, Savannahs and Coastal Issues

**Chair:** Corene Matyas

10:00	<i>Wrack: A geomorphic engineer in coastal foredune development</i>	Peter Tereszkievicz	University of South Carolina
10:20	<i>Mismatches in Reflectivity as Detected by Space- and Ground-Based Radars During Landfalling Tropical Cyclones</i>	Corene Matyas Zainab Ali Kimberly Wood Stephanie Zick	University of Florida University of Florida Mississippi State University Virginia Tech
10:40	<i>A Climatology of Extreme Intensity Change of North Atlantic and Eastern North Pacific Tropical Cyclones Prior to Landfall</i>	Nicholas Grondin Kelsey Ellis	University of Tenn. Knoxville University of Tenn. Knoxville
11:00	<i>Geomorphic Nesting Preferences of Sea Turtles on Santa Rosa Island, Florida</i>	Liliana Blouin Madison Williams Phillip Schmutz	University of West Florida University of West Florida University of West Florida

11:20	<i>Management Perspectives on the Impacts of Climate Change at Coastal Georgia Tourism Sites</i>	Reilly Corkran Amy Potter Phillip Schmutz	Louisiana State University Georgia Southern University University of West Florida
11:40	<i>A 4800-year record of vegetation and hydrology from a Belizean savanna</i>	Luke Blentlinger Sally Horn Chad Lane Jacob Cecil Cathy Smith Mathew Boehm	University of Tennessee University of Tennessee UNC Wilmington University of Tennessee University of Edinburgh University of Tennessee

## PAPER SESSION

**Location:** Conference D

## Geographies of Health II

**Chair:** Kelsey Ellis

10:00	<i>Overnight heat exposure in indoor and outdoor living spaces of Knoxville residents</i>	Kelsey Ellis Jenniger First Kristina Kintziger Christopher Fuhmann Ella Hunter	University of Tennessee University of Tennessee University of Nebraska NOAA Southeast Regional Climate University of Tennessee
10:20	<i>Hot in the City: Assessing household temperatures and youth personal exposure to extreme heat during a heatwave in urban Nashville, Tennessee</i>	Alisa Hass Adelle Montebalanco	Middle Tenn. State University Pacific University
10:40	<i>Ubiquitous Distribution but Racial Disparities Remain in Lead Exposure</i>	Charlie Zhang Kristina Zierold	University of Louisville U. Alabama -- Birmingham
11:00	<i>SPATIAL ANALYSIS OF MICROPLASTIC POLLUTION IMPACT ON ENVIRONMENTAL QUALITY AND HUMAN HEALTH IN NORTH CAROLINA</i>	Majemite Iyangbe Tony Esimaje	NC Central University NC Central University
11:20	<i>Identifying Emerging Space-time Radon Hot Spots Using Real-time Wireless Under-the-soil Radon Sensor Testbed</i>	Dajun Dai Sumya Tasnim Nadine Kabengi Brian Meyer Ashwin Ashok Nikhil Karve Abbaas Nishar	Georgia State University Georgia State University Georgia State University Georgia State University Georgia State University Georgia State University Georgia State University
11:40	<i>Sub-surface Lithological Control of Arsenic Pollution in Groundwater Along a 10km NE-SW Traverse in Haringhata Block, Nadia District, West Bengal</i>	Ayush Chaudhuri	UNC Greensboro

## PAPER SESSION

**Location:** Conference E

## Hazard Geographies

**Chair:** David Keellings

10:00	<i>Meteorological and Geographic Constraints on Rapid Comprehension of Tornado Warning Information</i>	Jason Senkbeil	The University of Alabama
10:20	<i>Developing a Combined Climate Extremes Resilience Index for the Conterminous United States</i>	Anuska Narayanan Brad Peter David Keellings	University of Florida University of Arkansas University of Florida
10:40	<i>An Intersectional Approach to Community Flooding Impact in Lowcountry South Carolina</i>	Marissa Mazariego Finn Gillette	Coastal Carolina University Coastal Carolina University

11:00	<i>Reanalyzed Environments and Land Cover Compositions of Southeastern Tornadoes with Abnormal Maximum Path Widths, 2000–2020</i>	Daniel Burow	Embry-Riddle Aeronautical Univ.
11:20	<i>Where's the Heat? Spatiotemporal Evolution of Heat Waves Across the U.S.</i>	David Keellings Erin Bunting Hamid Moradhani	University of Florida Michigan State University University of Alabama

## SPECIAL PAPER SESSION

**Location:** Conference 6

## Floods, Floodplains, and Fluvial Studies

**Co-Chairs:** Sarah Praskievicz and Joann Mossa

10:00	<i>Crevasses and Crevasse Splays, Apalachicola River floodplain, Florida</i>	Joann Mossa and Yin-Hsuen Chen	University of Florida
10:20	<i>Wetland Restorations on Fluvial Bottomlands in the Southern Blue Ridge Mountains</i>	David Leigh Jason Meador Paul Webb Scott Loftis Katie Price	University of Georgia Mainspring Conservation Trust, TRC Environmental NC Wildlife Resource Comm. Nutter & Associates, Inc.
10:40	<i>Anthropogenic channel network development in forested watersheds by recent stream channelization practices in Mark Twain National Forest, Missouri Ozarks</i>	Tasnuba Jerin, Missouri State University Robert T. Pavlowsky, Missouri State University Marc Owen, Missouri State University Joshua Hess, Missouri State University, Hannah Alkier, Missouri State University, Katie Grong, Missouri State University,	
11:00	<i>Large wood loads in channels and on floodplains after a 500-year flood using UAV imagery in Mark Twain National Forest, Ozark Highlands, Missouri</i>	Robert T. Pavlowsky, Missouri State University Joshua Hess, Missouri State University, Derek Martin, Appalachian State University, Toby Dogwiler, Missouri State University, Jacob Bendix, Syracuse University	
11:20	<i>Distribution of Large Wood in Coastal Plain Rivers of the Southeast US (Sarah Praskievicz, University of North Carolina Greensboro)</i>	Sarah Praskievicz, UNC Greensboro Derek Martin, Appalachian State Univ	
11:40	<i>High and dry: extreme floods and droughts in the French Broad River, Tennessee during the Common Era</i>	M.A. Lisa Davis Alexander Quimby Ray Lombardi Matthew Gage	University of Alabama University of Alabama University of Memphis University of Alabama

**POSTER SESSION**
**Location:** Conference 4

**Geospatial Methods Posters**

<i>Drought Monitoring and Communication in Tennessee</i>	William Tollefson Andrew Joyner Dalton Van Stratten Tristan Holmes	East Tennessee State University East Tennessee State University East Tennessee State University East Tennessee State University
<i>Estimating Treefall Direction of Jacksonville EF-3 Tornado</i>	Taylor Quarles Rachel Reid Saeideh Gharehchahi	Jacksonville State University Jacksonville State University Jacksonville State University
<i>Spatial Relationships Between Physical Campus Features and Campus Safety at Appalachian State University</i>	Dalton Akos	Appalachian State University
<i>Starting a Public Participatory GIS Project in the Rural South: Early Lessons and Future Plans</i>	Austin Abarr Kelsie Floyd Rob Yarbrough Michelle Thompson	Georgia Southern University Georgia Southern University Georgia Southern University Univ of New Orleans
<i>Optimization of species distribution models using a genetic algorithm for simulating climate change effects on Zagros forests in Iran</i>	Mohammad Safaei Hani Rezayan Parviz Zeaiane Javad Sadidi	University of Florida Kharazmi University Kharazmi University Kharazmi University
<i>Monitoring of Urban Heat Islands in Alabama</i>	Saeideh Gharehchahi Nicholas Looney	Jacksonville State University Jacksonville State University
<i>Urbanization and Habitat Suitability Threats to Red Salamander (<i>Pseudotriton ruber</i>) Habitat in Calhoun County, Alabama</i>	Christian Braswell Saeideh Gharehchahi	Jacksonville State University Jacksonville State University
<i>Analyzing Vulnerability to Climate Change Over Time and Climatically Induced Migration within the Southern United States (SEUS)</i>	Brandon Ryan Chandana Mitra	Auburn University Auburn University
<i>Multiple Gradual Maximal Covering Location Problem with Applications to Public Safety Operations</i>	Ashleigh Price	University of Alabama
<i>Title: Mapping Population Displacement Due to Riverbank Erosions on the Eastern Bank of the Lower Meghna Estuary, Bangladesh: A Geospatial Approach</i>	Israt Jahan Munshi Rahman	Georgia Southern University Georgia Southern University
<i>Pre and Post-cyclonic Change Assessment on the Sundarbans Mangrove Forest using Radar and Optical Remote Sensing Imagery</i>	Syeda Nazifa Tasneem Chandana Mitra	Auburn University Auburn University
<i>Spatial and Temporal variation in Social Determinants of Health (SDH) and COVID-19 related health outcomes in the United States.</i>	SM Asger Ali Kathleen Sherman-Morris Qingmin Meng Shrinidhi Ambinakudge	Mississippi State University Mississippi State University Mississippi State University Mississippi State University Mississippi State University
<i>Spatiotemporal riverbed deformations of the Lower Apalachicola River, Florida</i>	Ali Alruzuq Joann Mossa Yin-Hsuen Chen	University of Florida University of Florida Old Dominion University

## 12:00 noon to 1:00 PM

### Stand-Alone Geographers (SAGE) Lunch (group members only)

Private Room 1 (Restaurant)

## 1:00 PM to 3:00 PM

### Rivers, Floods and Drought

Location:

Conference C

Chair: Johanna Engström

1:00	<i>Drought vulnerability in Southeastern United States</i>	Johanna Engström	University of Florida
1:20	<i>Flood fatalities in Nigeria and the United States of America: A comparative study.</i>	Emmanuel Ologunorisa Omolola Ologunorisa	Olusegun Agagu University of Science and Technology Olusegun Agagu University of Science and Technology, Nigeria
1:40	<i>Evaluating Water Quality of Tennessee River in North Alabama</i>	Zhuyun Ma Jian Chen	University of North Alabama University of North Alabama
2:00	<i>Developing Full Length 3D-Riverscapes of Local Hydrology Using Terrestrial LiDAR</i>	Ranbir Kang	Kennesaw State University
2:20	<i>Sensitivity of River Channel Morphology in Small Piedmont Watersheds, North Carolina State, United States</i>	Shamusideen Ayeni Dan Royal	UNC Greensboro UNC Greensboro

### PAPER SESSION

Location:

Conference D

### Urban Geography II

Chair: James Tyner, Kent State University

1:00	<i>Bidding Farewell to Herman the German: Demilitarization and Industrial Ruination in Long Beach, California</i>	James Tyner	Kent State University
1:20	<i>Implications of the growth of Single-Family Rentals (SFRs) communities on African American Community in Rutherford County, TN</i>	Rafael Harun Ken Chilton	Tennessee State University Tennessee State University
1:40	<i>The Cost of Green Infrastructure and the Price Residents Pay</i>	Brandon North	Georgia State University
2:00	<i>Blocking Out the Sun: Uneven Geographies of Solar Adoption in Atlanta, Ga</i>	Carys Behnke	Georgia State University
2:20	<i>Investigating the Image and Future of Leesburg, Virginia</i>	Ryan Shayer Robert Oliver Korine Kolivras Margret Cowell	Virginia Tech Virginia Tech Virginia Tech Virginia Tech
2:40	<i>Mapping the inter-metropolitan geographies of large corporate single-family landlords</i>	Taylor Shelton Eric Seymour Stephen Sherman Joshua Akers	Georgia State University Rutgers University Rice University

**PAPER SESSION****Location:** Conference E**Geographies of the American South****Chair:** AJ Kim, San Diego State University

1:00	<i>Unequal Suburbs: Immigrant Integration in the New South</i>	AJ Kim	San Diego State University
1:20	<i>Finding a Vernacular South: 1910 to 1930</i>	Jesse Andrews	University of Nebraska Kearney
1:40	<i>As Goes the South Towards a Just Transition for Communities and Workers in the U.S. South</i>	T'Shari White Connor Harrison Shelley Welton Ann Eisenburg Etienne Toussaint Nikki Luke	University of South Carolina University of South Carolina University of Pennsylvania University of South Carolina University of South Carolina University of Tennessee
2:00	<i>Using Interviews to Explore the Reasons for the Support of Solar Energy in Florida Gulf Coast Counties</i>	Kaylin Colvin Reece	University of West Florida
2:20	<i>Banking on Location: Views of Financial Exclusion in the Atlanta Metro</i>	Ryan Pardue	Georgia State University
2:40	<i>Post-Coal Futures: A Critique of the ARC's Economic Development Model</i>	Caleb Gore	University of Tennessee--Knoxville

**PAPER SESSION****Location:** Conference 6**Cultural Symbols & Geographies****Chair:** Douglas Allen, Unaffiliated

1:00	<i>The Toronto Music Garden: the making of an affective music landscape</i>	Robert Kruse	West Liberty University
1:20	<i>Postage Stamps as Indicators of Geopolitical Change: The Case of the Caribbean Island of Grenada</i>	Thomas Bell	University of Tennessee
1:40	<i>Three vignettes of a billboardscape</i>	Michael McCanless Jacob Saindon Matthew Wilson	University of Kentucky University of Kentucky University of Kentucky
2:00	<i>White Crosses on the Interstate: Automobile Accidents and Memorialization on Alabama Highways</i>	Daniel McGowin	Jacksonville State University
2:20	<i>Symbolic Transference: Public Symbols and the Spatiality of Affective Resonance</i>	Douglas Allen Christabel Devadoss	Unaffiliated Middle Tennessee State University
2:40	<i>Remembrance of the Ottoman occupation, Muslim related sentiments and local identity in Szigetvár (Hungary) the death place of Suleiman the Magnificent</i>	Péter Reményi Norbert Pap László Kákai Viktor Glied Gábor Szalai Máté Kitánics	University of Pécs University of Pécs University of Pécs University of Pécs University of Pécs University of Pécs

**PAPER SESSION****Location:** Conference 7**Spatialities of Disability in the US South and Abroad**

Rose Shelor, University of Tennessee, Knoxville and

**Chairs:** LaToya Eaves, University of Tennessee, Knoxville

1:00	<i>Unnatural Disasters: Climate Change, Disability and Marginalization: Bodies Left Behind in Crisis</i>	Morgan Shelor	University of Tenn. Knoxville
1:20	<i>The Fragility of Disability Accommodations and the Need to Make them More Dependable</i>	Adam Cureton	University of Tennessee
1:40	<i>Forging Intersectional Fugitive Spaces of Justice - Embodied Stories from Athens, Georgia</i>	Jess Martinez	University of Georgia
2:00	<i>(De)Constructing Ivy Green: Geographies of Disability &amp; Tourism at Helen Keller's Birthplace</i>	Ethan Bottone	Northwest Missouri State
2:20	<i>"I Rarely Go Out on Work Days": Space-Time Constraints and Im(mobility) Experiences among Indonesian Female Domestic Workers in Hong Kong</i>	Fikriyah Winata	Mississippi State University
2:40	<i>Mapping and Measuring Physical Activity Access Disparity (PAD) index based on Youth-Related Environment</i>	Jue Yang Lan Mu Janani Thapa	University of Georgia University of Georgia University of Georgia

**PAPER SESSION****Location:** Conference B**Global Geographies****Chair:** Keith Waters, Arizona State University

1:00	<i>Pastoralist responses to insecurity in three regions of Mali</i>	Matthew Pflaum	University of Florida
1:20	<i>Ch'orti' Perceptions of Environmental Risks in Olopa, Guatemala</i>	Meghan Albritton Korine Kolivras Benjamin Chang  Nicholas Copeland Guadalupe Garcia Prado Leigh-Anne Krometis	Virginia Tech Virginia Tech Observatorio de Industrias Extractivas Virginia Tech Observatorio de Industrias Extractivas Virginia Tech
1:40	<i>Understanding the Drivers of Landscape Change and Degradation on Sonadia Island, Bangladesh</i>	Md Muyeed Hasan Md Tariqul Islam Jane Southworth Md Najmul Kabir Minhaz Hasan Sujan Debjani Das	University of Florida Shahjalal University of Sci + Tech University of Florida Shahjalal University of Sci + Tech Shahjalal University of Sci + Tech University of Florida
2:00	<i>Patterns and Associations of Shoreline Erosion and Developed Land Use Change in the Lower Meghna Estuary of Bangladesh</i>	Nazmul Huda Thomas Crawford	Virginia Tech Virginia Tech

2:20	<i>Comparison of the Wind Power Landscapes in South Africa and the United States of America</i>	Natalia Dambe Johanna Engström	University of Florida University of Florida
2:40	Global Palm-Oil Trade: A Network Analysis Approach	Keith Waters Shade Shuttters	Arizona State University Arizona State University

## PANEL SESSION

**Location:** Salon 1,2, & 3

### Imposter Syndrome: Let's Break the Stigma

**Chair:** Stephanie Insalaco, Univ. of Tennessee Knoxville  
**Panelists:** Derek Alderman, University of Tennessee Knoxville  
 Dr. Brian Williams, Mississippi State University  
 Destiny Crockett, Mississippi State University  
 Dr. Ingrid Luffman, East Tennessee State University  
 Dr. Christa Smith, Clemson University

**Description:** Imposter syndrome (the feeling of doubting your abilities or feeling like a fraud) has spread through academia, but especially since the onset of the COVID-19 pandemic. This syndrome is rarely discussed, and probably has affected people you work closely with. Professors and current graduate students will join together at this panel to discuss their experiences with imposter syndrome and how we can combat it. Bring an open mind and your questions, and let's break the stigma on imposter syndrome together.

## POSTER SESSION

**Location:** Conference 4

### POSTER SESSION

<i>Urbanization and Solid Waste Management in Urban Ghana. A case study of Accra.</i>	Olivia Ainooson	Auburn University
<i>Estimating the Risk of Wind Damage from Hurricanes to Medium Sized Cities Along the Gulf of Mexico</i>	Miranda Silano Chandana Mitra	Auburn University Auburn University
<i>Ground-level Ozone Spatiotemporal Modeling Using a Novel WRF-coupled Deep-learning Approach</i>	Mostafa Rezaali Mohammad Jahangir John Quilty David Keelings	University of Florida University of Waterloo University of Waterloo University of Florida
<i>Seeking a Community-Based Climate Action Agenda in Greenville, South Carolina</i>	Haley Hopkins Matthew Cohen	Furman University Furman University
<i>What is the Potential for a City Sustainability Plan to Address the Climate Crisis?</i>	Elizabeth Santi Matthew Cohen	Furman University Furman University
<i>Determining relationships between demographic variables and their impacts on water access in India</i>	Emily Wilcox Luke Juran	Virginia Tech Virginia Tech
<i>Analyzing mining district change using repeat photography: A case study of Ely and Eureka, Nevada</i>	Hunter Carlton Isaac Bowling Michael Pretes	University of North Alabama University of North Alabama University of North Alabama
<i>Queering Biography: Sigismond Diettrich and the Death of a Career</i>	Jack Swab	University of Kentucky
<i>Extracting topography from historic maps using deep learning</i>	Briar Pierce Eileen Ernenwein	East Tennessee State University East Tennessee State University



<i>Map Similarity Analysis: Using Historical Maps, Geophysics, and Statistical Analysis to Examine the Site of Presidio Los Adaes, Capital of Spanish Texas in the Mid 1700s</i>	Eileen Ernenwein Bob Linam	East Tennessee State University East Tennessee State University
<i>Mapping Transportation Fuel Usage for SEDAAG States</i>	Doug Oetter	Georgia College & State University
<i>Where are Electric Vehicles? Spatial Mismatch between AFV and EJ in Maryland</i>	Sheila Jebiwot	UNC Greensboro
<i>Exploratory Analysis of FEMA Individual Assistance for Tropical Cyclone Induced Flooding</i>	Sarah VanSchoick Corene Matyas Kevin Ash	University of Florida University of Florida University of Florida
<i>Erasure and Remembrance of an African American Neighborhood: Reimagining Jonesville through Story Maps</i>	Margaret Gripshover Amy Nemon	Western Kentucky University Western Kentucky University
<i>Geographies of Rock and Roll: Sabaton</i>	Chase Womack	UNC Greensboro

## 3:10 PM to 5:10 PM

### SPECIAL PAPER SESSION

**Location:** Salon 1, 2, & 3

### Applications in Dendrochronology

**Organizers:** Jared Friedman, Clay Tucker, Maegen Rochner, Avery Catherwood

**Chairs:** Jared Friedman, University of Alabama and Clay Tucker, U. of Southern Mississippi

3:10	<i>Applied Dendrochronology in Gwinnett County Parks, Georgia: Student Participation in Community Outreach</i>	Joseph Henderson David Dorrell	Georgia Gwinnett College Georgia Gwinnett College
3:30	<i>A Multi-Century Fire History from the Potomac Highlands of West Virginia</i>	Stockton Maxwell Thomas Saladyga	Radford University Concord University
3:50	<i>Dendroecological Potential of Riverscours Woodland Tree Species</i>	Haidyn DePinho Thomas Saladyga	Concord University Concord University
4:10	<i>Reconstructing Tropical Cyclone Precipitation through Oxygen Isotope Ratios in Baldcypress (Taxodium distichum)</i>	Jared Friedman Clay Tucker Emily Elliott Matthew Therrell Joshua Bregy Jessie Pearl	University of Alabama University of Southern Miss University of Alabama University of Alabama Indiana State University The Nature Conservancy
4:30	<i>Pathogen Infestation and its Effects on Reconstructing Climate from Eastern Hemlock in Great Smoky Mountains National Park, Tennessee</i>	Savannah Collins-Key Matthew Bekker Sally Horn Jeffrey Collins-Key Matthew Kerr	University of Tennessee Brigham Young University University of Tennessee University of Tennessee University of Tennessee
4:50	<i>Applications of Dendroarchaeological Data for Understanding Paleoenvironmental Change: Opportunities and Challenges</i>	Maegen Rochner Kristen de Graauw Saskia van de Gevel Amy Hessel	University of Louisville Kennesaw State University Appalachian State University West Virginia University

**PAPER SESSION****Location:** Conference C**Economic Geography****Chair:** William Canup, University of NC at Greensboro

3:10	<i>Citizenship/Residency-by-Investment Programs in the Caribbean: Case Studies of St. Kitts &amp; Nevis, Antigua &amp; Barbuda, and Anguilla</i>	William Canup	UNC Greensboro
3:30	<i>'Fear of Hunger' among Central American Migrants in Mississippi</i>	Christian Scott Shrinidhi Ambinakudige Domenico Parisi	Mississippi State University Mississippi State University Mississippi State University
3:50	<i>Indigenous Legalities, Pipeline Viscosities</i>	Tyler McCreary	Florida State University
4:10	<i>Geographies of Intra-urban Diversity and the Foreign-born: An Empirical Perspective of Rent Burden Index in Nashville, Tennessee</i>	Madhuri Sharma Mikhail Samarin	University of Tennessee University of Tennessee
4:30	<i>An Introduction to Outer Space Geographies</i>	Chase Womack	UNC Greensboro

**PAPER SESSION****Location:** Conference D**Innovative Approaches to Geographic Teaching**

Kathleen Sherman-Morris, Mississippi State

**Chair:** Univ.

3:10	<i>Using a sketch mapping activity to examine tornado risk personalization</i>	Kathleen Sherman-Morris Jason Senkbeil Asger Ali Cole Vaughn	Mississippi State University University of Alabama Mississippi State University Mississippi State University
3:30	<i>A Changing Geography of Online Language Instruction in the Age of COVID?</i>	Arnold Modlin Yudinel Valdez Carabaollo	Norfolk State University Universidad Tecnológica de Santiago
3:50	<i>Cross-disciplinary teaching and learning projects: reflections from a historian and a geographer on content, design, and pedagogy</i>	Todd Lindley Ryan Gaston	Georgia Gwinnett College Georgia Gwinnett College
4:10	<i>Teaching Meteorology and Myth in General Education</i>	Dennis Edgell	UNC Pembroke
4:30	<i>Analysis of Online Visibility of Sustainability Programs at UNC System Universities and North Carolina Community Colleges</i>	Samuel Akinnusi Tony Esimaje Christopher McGinn Gordana Vlahovic	North Carolina Central Uni. North Carolina Central Uni. North Carolina Central Uni. North Carolina Central Uni.

**SPECIAL PAPER SESSION**

Location: Conference E

**Spatializing Difference: Emerging Research on Race, Gender, and Sexuality in the South**

Chair: LaToya E. Eaves, University of Tennessee, Knoxville

3:10	<i>Forced Displacement and Covered Monuments: Black Erasure at Centennial Park in Nashville, Tennessee</i>	Kayla Roulhac	University of Tenn. Knoxville
3:30	<i>Queer Joy: Knoxville, Tennessee</i>	Devyn Kelly	University of Tenn. Knoxville
3:50	<i>Examining housing experiences among International Students at UTK</i>	Rosemary Ayelazuno	University of Tenn. Knoxville
4:10	<i>A City of Queers in the Forest: Trans Care Relations and the Fight to Defend Atlanta's Forests</i>	Arin Yost	Georgia State University
4:30	<i>Getting Your House in Order: Learning from Messy Methodologies in a Feminist Geography Analysis of Housing Justice</i>	Sam Myers-Miller	Vanderbilt University
4:50	<i>Scars as Cartography: Bodily Commemorations and Memorials</i>	Bethany Craig	The University of Kentucky

**SPECIAL PAPER SESSION**

Location: Conference 6

**Memory-Work II: Creative Knowledges and Community Engagement**

Organizers: Derek H. Alderman, University of Tennessee and Rebecca Sheehan, Oklahoma State University

Chair: Rebecca Sheehan, Oklahoma State University Sheehan

3:10	<i>Re-rendering Space at the Margins of Geographic Knowledge</i>	Christy Hyman	Mississippi State University
3:30	<i>Fredericksburg's Civil Rights Trail: reparative memory work as mapping practice</i>	Stephen Hanna	University of Mary Washington
3:50	<i>Teaching geographies of memory: A call for college curriculum inclusion</i>	Matthew Cook	Eastern Michigan University
4:10	<i>Queering Biography: Sigismond Diettrich and the Death of a Career</i>	Jack Swab	University of Kentucky
4:30	<i>Stitching memories: Reclamation of memory through a quilt memorial for Greenwood</i>	Katrina Ward	Oklahoma State University
4:50	<i>Comic Books as Tools of Resistance: On the Creative Geographies of SNCC's Research Department in Atlanta, Georgia</i>	Derek Alderman Josh Inwood	University of Tennessee Penn State University

## 3:10 PM to 4:10 PM

### PANEL SESSION

Location: Conference 7

#### Notes From the Field:

#### Reflections on Using Novel Approaches and Incorporating New Skills for Field Research

**Organizer & Co-Chairs:** Mario Mighty & Matthew Balentine, Univ. of North Alabama

**Sponsor:** SEDAAG Education Committee

**Discussants:** Mario Mighty, University of North Alabama

Jennifer Rahn, Samford University

Matthew Balentine, University of North Alabama

Michael Pretes, University of North Alabama

**Description:** Panelists will talk briefly about some examples of new skills that they have incorporated into field research and then a discussion about other novel approaches by audience participants will follow. Come share your new methods with us!

## 4:10 PM to 5:10 PM

### PANEL SESSION

Location: Conference 7

#### Teaching Introduction to Geographic Information Science: Best Practices and Reflections

**Organizer:** Caroline McClure

**Sponsor:** SEDAAG Education Committee

**Chair:** Jonathan Fleming, Samford University

**Panelists:** Caroline McClure

Jonathan Fleming, Samford University

Jordan Cissell, Samford University

**Description:** Many early-career faculty in Geography and Geoscience departments are placed in a classroom teaching an Introduction to GIS course, with or without prior teaching experience. While GIS is broadly used in research, teaching experiences are less available. This session will compare practices and discuss methods for teaching such a course. It will bring together a diverse group of faculty, all currently teaching Intro GIS courses. The participants will share their experience teaching the course, their format for the course, and what does and does not work in the classroom (projects vs. exams, teaching both lecture and lab vs. teaching lecture with TAs teaching labs, types of projects, etc., ESRI software vs. others, hybrid vs. face-2-face vs. online, etc.). Anyone interested is invited to also share their experiences in teaching the course, along with ideas on how to give students the best experience concerning learning GIS.

## 5:00 PM to 6:00 PM

### SEDAAG Business Meeting

Conference B

## **6:00 PM to 7:15 PM**

<b>World Geography Bowl Championship</b>	Salon 1,2,3
--	-------------

## **7:30 PM to 9:30 PM**

<b>Honors Banquet and Plenary Address</b>	Salon 4, 5, 6
---	---------------

# VENUE FLOOR PLANS

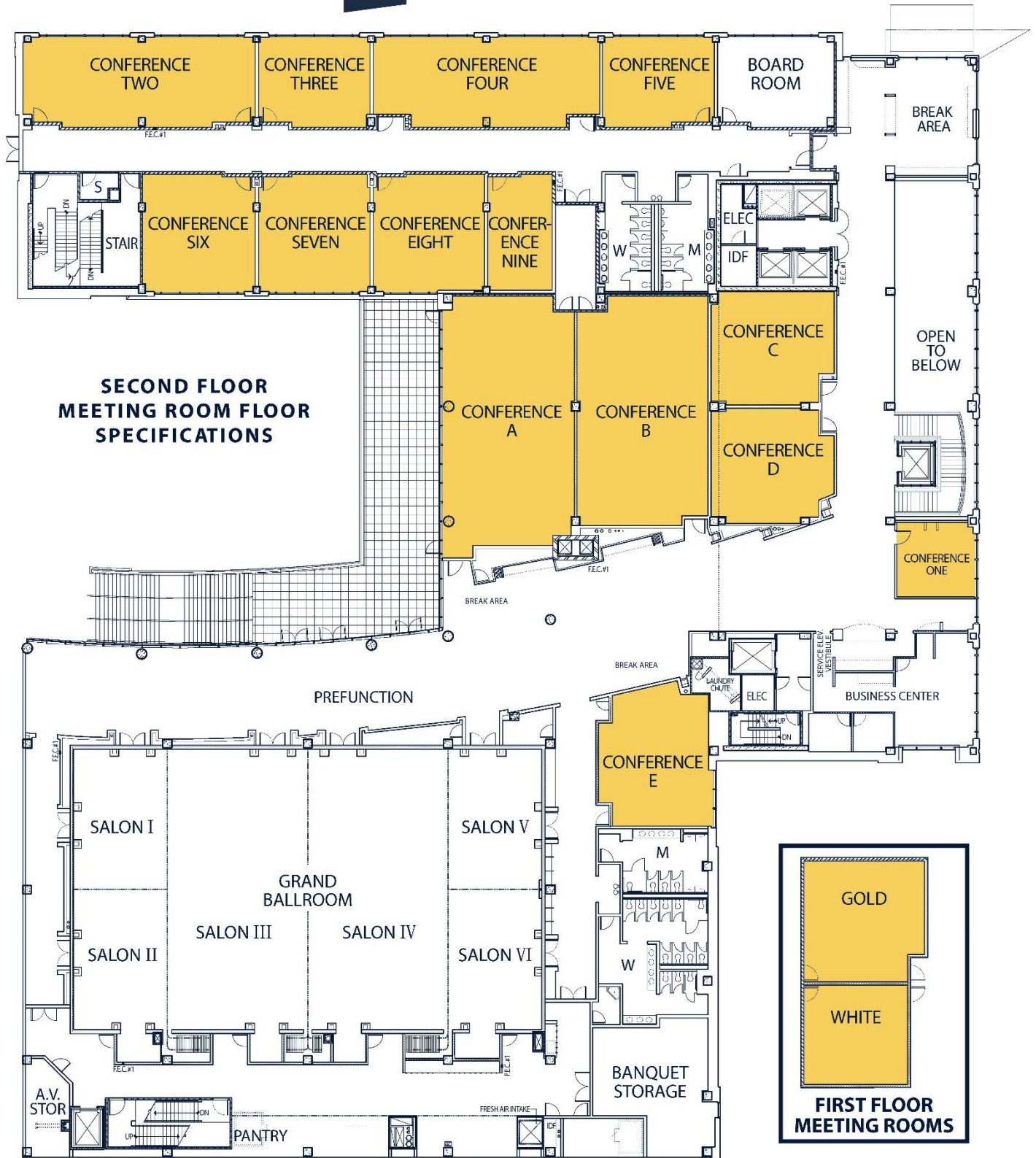

## **COVID-19 MITIGATION**

SEDAAG *highly encourages* the use of masks in public spaces regardless of vaccination status. We are committed to protecting public health and will follow all safety measures based on the guidelines from the Centers for Disease Control, Georgia Public Health, and hotel requirements. We continue to monitor changes and will post or announce updates related to the impact of COVID-19.

## **EVENT CONDUCT POLICY**

Professional ideas and information are exchanged most effectively at the SEDAAG Annual Meeting and other SEDAAG events in an atmosphere free of discrimination or harassment and characterized by courtesy and respect. To that end, the SEDAAG expects all individuals who attend the regional conference or who participate in other SEDAAG-sponsored events to conduct themselves in a manner that establishes an atmosphere free from discriminatory practices. All participants are expected to treat others with respect and consideration, follow venue rules, and alert staff or security when they have knowledge of dangerous situations, violations of this Event Conduct Policy, or individuals in distress. This Conduct Policy applies to all attendees and participants at any SEDAAG-sponsored event, including in online venues, and at SEDAAG-sponsored meeting social events. All who register to participate, attend, speak at, or exhibit at an SEDAAG event agree to comply with this Policy.

## NOTES: